



**CHAMPAIGN  
PARK DISTRICT**

**SPECIAL MEETING  
BRESNAN MEETING CENTER  
706 Kenwood Road, Champaign, Illinois  
Wednesday, June 27, 2018  
5:30 p.m.**

**A. CALL TO ORDER**

**B. PRESENTATIONS**

1. Centennial Park Detention, Champaign Unit 4 School District

**C. COMMENTS FROM THE PUBLIC:** *Comments must be limited to not more than three (3) minutes.*

**D. NEW BUSINESS**

1. Approval of Budget Line Transfers

Staff recommends approval of line item transfers of the FY18 budget be made within funds where lines will exceed their original budget. The transfers do not affect the overall budget as other line items would be decreased within the same funds. This is being done to comply with the Park Code and for audit purposes.

**E. DISCUSSION ITEMS**

1. FY19 Annual Operating Budget

**F. COMMENTS FROM COMMISSIONERS**

**G. EXECUTIVE SESSION**

The Board will convene into Executive Session under the Illinois Open Meetings Act, specifically 5 ILCS 120/2(c)(1) for the discussion of the appointment, employment, compensation, discipline, performance, or dismissal of specific employees of the public body, or legal counsel for the public body.

**H. RETURN TO REGULAR MEETING**

**I. EXECUTIVE SESSION ACTION ITEM**

1. Approval of Wage Increase for the Executive Director for FY19

**J. ADJOURN**

## **EASEMENT AGREEMENT**

### **Storm Water Detention**

THIS EASEMENT AGREEMENT is made and entered into as of the \_\_\_\_ day of June, 2018, by and between THE CHAMPAIGN PARK DISTRICT, an Illinois municipal corporation, (hereinafter referred to as "Grantor") and BOARD OF EDUCATION OF CHAMPAIGN COMMUNITY UNIT SCHOOL DISTRICT NO. 4, an Illinois independent school district (hereinafter referred to as "Grantee").

The following recitals of fact are a material part of this instrument:

- A. Grantor is the owner of the fee simple interest in certain Champaign County, Illinois, real estate further described on Exhibit A attached hereto, incorporated by reference herein and hereinafter referred to collectively as the "Servient Tract";
- B. Grantee is the owner of certain Champaign County, Illinois, real estate further described on Exhibit B attached hereto, incorporated by reference herein and hereinafter referred to collectively as the "Dominant Tract";
- C. Grantee is currently developing the Dominant Tract with a multi-use sports facility including an artificial surface football field; and
- D. Grantor wishes to grant to Grantee and Grantee wishes to receive from Grantor a non-exclusive easement to benefit the Dominant Tract on, over and across the Servient Tract for storm water conveyance and detention and construction and maintenance of any storm water conveyance or detention facilities or improvements (collectively, the "Stormwater Management Facilities") as further depicted on Exhibit C attached hereto and incorporated by reference herein.

NOW, THEREFORE, in consideration of Ten Dollars (\$10.00) and other good and valuable consideration, the receipt and sufficiency of which is hereby acknowledged by all parties hereto, the parties hereby agree as follows:

1. Grant of Easement - Grantor does hereby give, grant, bargain and convey to Grantee, its successors and assigns, as an easement appurtenant to the Dominant Tract, a non-exclusive easement on, over and across the Servient Tract for the Stormwater Management Facilities.
2. Construction and Maintenance – The cost of constructing and installing the Stormwater Management Facilities shall be paid one hundred percent (100%) by Grantee. The Stormwater Management Facilities shall only be built in accordance with plans and specifications approved by Grantor, whose approval will not be unreasonably withheld, conditioned or delayed. The cost of maintaining the Servient Tract, including but not limited to mowing and removal of any sediment, shall be borne by Grantee.
3. Retained Rights - Subject to the rights granted to Grantee hereby, Grantor retains all rights to the ownership, use and occupancy of the Servient Tract.
4. Authority - Grantor warrants that it has full power and authority to enter into this Easement Agreement and to grant the rights contained herein.
5. Interpretation - The rule of strict construction does not apply to this Easement Agreement. This document shall be given a reasonable construction so that the intention of the parties to confer the commercially usable right of enjoyment on Grantee in and to the Servient Tract for storm water conveyance and detention for the benefit of the Dominant Tract is carried out.
6. Enforcement - The parties hereto acknowledge and agree that any party to this Easement Agreement may enforce and compel performance of the parties hereto of the terms hereof by any and all remedies available at law or equity. The prevailing party in any such action shall be entitled to attorney fees and court costs.

IN WITNESS WHEREOF, this Easement Agreement is entered into and effective as of the day and year first above written.

**GRANTOR:**

**GRANTEE:**

THE CHAMPAIGN PARK DISTRICT  
An Illinois municipal corporation

BOARD OF EDUCATION OF  
CHAMPAIGN COMMUNITY UNIT  
SCHOOL DISTRICT NO. 4,  
An Illinois independent school district

By: \_\_\_\_\_  
Name: \_\_\_\_\_  
Title: \_\_\_\_\_

By: \_\_\_\_\_  
Chris Kloeppel, Its President

By: \_\_\_\_\_  
Susan Zola, Its Superintendent

STATE OF ILLINOIS                    )  
  )        SS  
COUNTY OF CHAMPAIGN            )

I, THE UNDERSIGNED, a Notary Public in and for said County, in the State aforesaid, do hereby certify that \_\_\_\_\_, as \_\_\_\_\_ of THE CHAMPAIGN PARK DISTRICT, an Illinois municipal corporation, personally known to me to be the same person whose name is subscribed to the foregoing instrument, appeared before me this day in person and acknowledged that the said instrument was signed and delivered as the free and voluntary act of said municipal corporation, for the uses and purposes therein set forth.

GIVEN UNDER MY HAND and notarial seal this \_\_\_\_\_ day of June, 2018.

\_\_\_\_\_  
Notary Public



STATE OF ILLINOIS                    )  
  )    SS  
COUNTY OF CHAMPAIGN            )

I, THE UNDERSIGNED, a Notary Public in and for said County, in the State aforesaid, do hereby certify that CHRIS KLOEPEL, as President of BOARD OF EDUCATION OF CHAMPAIGN COMMUNITY UNIT SCHOOL DISTRICT NO. 4, an Illinois independent school district, personally known to me to be the same person whose name is subscribed to the foregoing instrument, appeared before me this day in person and acknowledged that the said instrument was signed and delivered as the free and voluntary act of said independent school district, for the uses and purposes therein set forth.

GIVEN UNDER MY HAND and notarial seal this \_\_\_\_\_ day of June, 2018.

\_\_\_\_\_  
Notary Public

STATE OF ILLINOIS                    )  
  )    SS  
COUNTY OF CHAMPAIGN            )

I, THE UNDERSIGNED, a Notary Public in and for said County, in the State aforesaid, do hereby certify that SUSAN ZOLA, as Superintendent of BOARD OF EDUCATION OF CHAMPAIGN COMMUNITY UNIT SCHOOL DISTRICT NO. 4, an Illinois independent school district, personally known to me to be the same person whose name is subscribed to the foregoing instrument, appeared before me this day in person and acknowledged that the said instrument was signed and delivered as the free and voluntary act of said independent school district, for the uses and purposes therein set forth.

GIVEN UNDER MY HAND and notarial seal this \_\_\_\_\_ day of June, 2018.

\_\_\_\_\_  
Notary Public

**PREPARED BY AND FOLLOWING  
RECORDATION RETURN TO:**

PATRICK T. FITZGERALD  
Meyer Capel, A Professional Corporation  
306 West Church Street  
Post Office Box 6750  
Champaign, Illinois 61826-6750  
Telephone: (217) 352-1800

**EXHIBIT A**

[Legal Description to come]

**EXHIBIT B**

[Legal Description to come]

EXHIBIT C

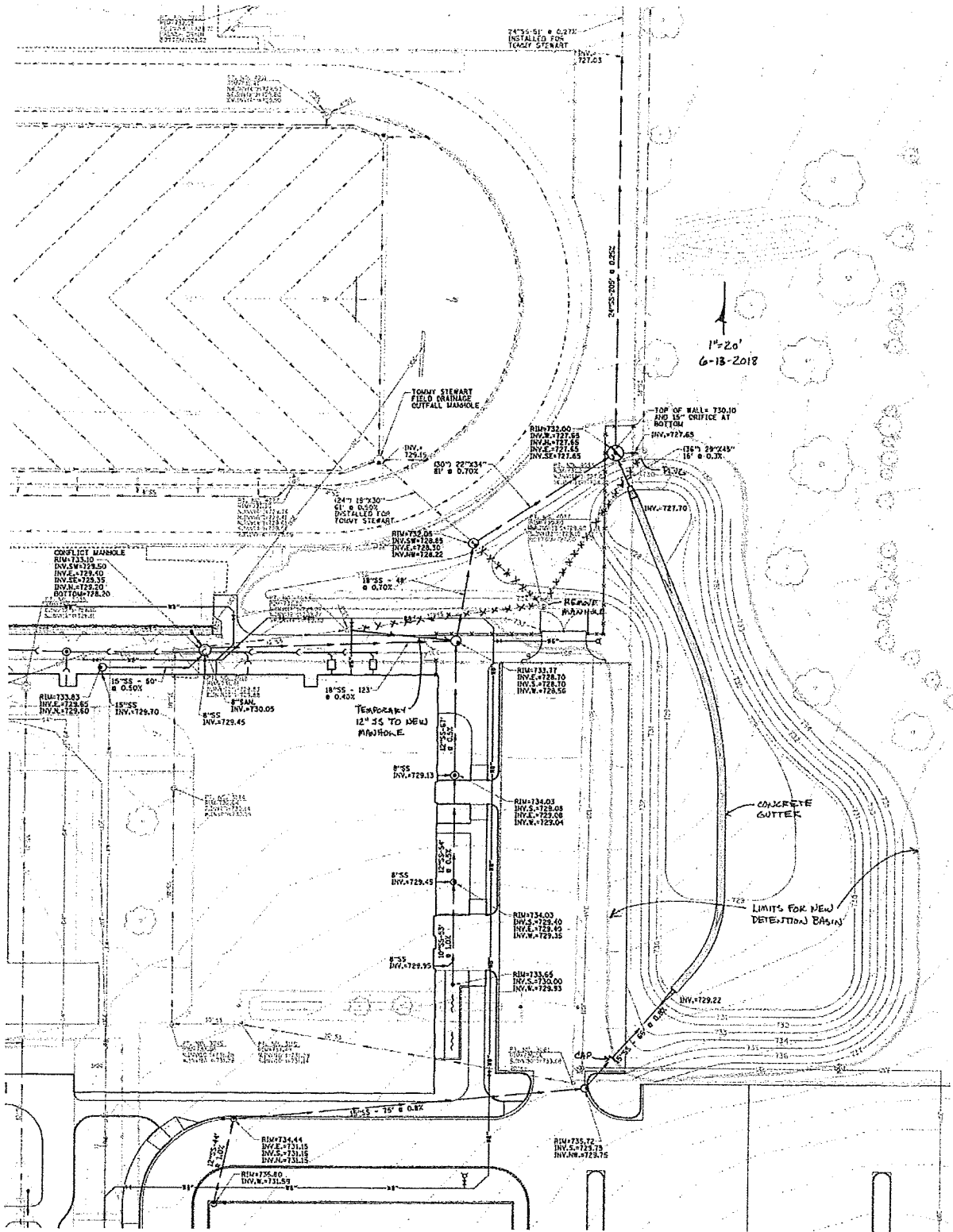



# Daily Log Report - Fill In Form

conducted for

**5941 TS**

**Conducted on**  
6/12/18, 8:00 AM

**Prepared by**  
Dale Aldrich

## Daily Log Report

<b>Daily Work Description</b>		
	<p>Well it rained about 3-3/4" over the weekend, and it has ruined the football field and all of the drain tile work that Duce has already put in.</p> <p>The mass amounts of water has caused the tiles to float up, so now they will all need removed and replaced.</p> <p>Cross poured the second half of the radius curb around the north end. It looks real nice. They are really doing a good job.</p>	
<b>Equipment</b>		
<b>Coordination / Issues / Events</b>		
	The biggest issue is the standing water and lots of mud.	
<b>Weather Conditions</b>		
High Temperature	80	
Elements	Overcast, Partly Cloudy	





























# CHAMPAIGN PARK DISTRICT

## REPORT TO PARK BOARD

**FROM:** Joe DeLuce, Executive Director

**DATE:** June 22, 2018

**SUBJECT:** Approval of 2017-18 Budget Line Transfers

### Background

In accordance with the Park District Code, the Board of Commissioners may approve the transfer of budget line transfers not to exceed 10% of the total appropriations specified in the Budget and Appropriations Ordinance by fund where expenditures exceed budget. The transfers do not affect the overall budget as other line items would be decreased within the same fund. This is completed annually to comply with the Park Code and for audit purposes.

Individual line items and programs were the basis for the budget line transfers. Total budget line transfers equal \$426,308.10 with 70% (\$299,218.10) of the changes occurring in the Recreation, Museum (excludes Virginia Theatre) and Special Recreation Funds. The total transfers made by fund were less than the 10% limit.

General Fund - \$112,660.07 (represents 2.0% of original operating budget)  
Recreation Fund - \$174,501.53 (represents 5.0% of original operating budget)  
Museum Fund - \$58,355.47 (represents 2.3% of original operating budget)  
Liability/Insurance Fund - \$6,479.00 (represents 2.0% of original operating budget)  
Activity Fund - \$822.00 (represents 8.7.0% of original operating budget)  
Special Recreation Fund - \$66,361.06 (represents 9.6% of original operating budget)  
Martens Center Fund - \$7,129.00 (represents 7.0% of original operating budget)

Attachment A1 – summary of budget category net transfers by fund

Attachment B1 – detail of budget line transfers by individual line item and department

Of the total budget line transfers above, the gross added via transfers to salaries/wages budget line for the above funds was \$189,779, however this was offset by savings in other salary lines by \$175,667 (full-time \$28,292 and part-time \$147,375) for a net increase of \$14,112.

### Prior Board Action

The Board of Commissioners adopted Ordinance No. 620 July 26, 2017 in the amount of \$19,864,806.

### Recommended Action

Staff recommends Board approval of line item transfers of the FYE18 budget be made within funds where lines will exceed their adopted budget per the attached document.

Prepared by:

Andrea N. Wallace  
Director of Finance

Reviewed by:

Joe DeLuce, CPRP  
Executive Director

---

The mission of the Champaign Park District is to enhance our community's quality of life through positive experiences in parks, recreation, and cultural arts.



SUMMARY OF BUDGET LINE TRANSFERS REPORT FOR CHAMPAIGN PARK DISTRICT  
 FYE2018 ORIGINAL BUDGET WITH BUDGET LINE TRANSFERS  
 MAY 1, 2017 THROUGH APRIL 30, 2018

Fund - Budget Category	ADOPTED BUDGET	NET TRANSFERS	FINAL AMENDED BUDGET	YTD ACTUAL	PCT OF BUDGET USED
<b>Fund 01 - GENERAL</b>					
SALARIES AND WAGES	2,466,675.00	13,601.00	2,480,273.00	2,440,875.00	98.41%
FRINGE BENEFITS	370,539.00	(90.00)	370,449.00	367,958.00	99.33%
CONTRACTUAL	845,165.00	(5,630.00)	839,535.00	694,454.00	82.72%
COMMODITIES	472,857.00	(13,403.00)	459,454.00	362,162.00	78.82%
UTILITIES	151,817.00	385.00	152,202.00	139,763.00	91.83%
PERIODIC/ ROUTINE MAINTENANCE	235,700.00	5,137.00	240,837.00	195,390.00	81.13%
TRANSFERS TO OTHER FUNDS	1,058,700.00	0.00	1,058,700.00	1,058,700.00	100.00%
TOTAL FOR FUND 01 EXPENDITURES	<u>5,601,453.00</u>	<u>0.00</u>	<u>5,601,450.00</u>	<u>5,259,302.00</u>	<u>93.89%</u>
<b>Fund 02 - RECREATION</b>					
SALARIES AND WAGES	1,864,661.00	(6,482.00)	1,858,179.00	1,779,425.00	95.76%
FRINGE BENEFITS	149,962.00	323.00	150,285.00	146,361.00	97.39%
CONTRACTUAL	436,078.00	(4,194.00)	431,884.00	356,694.00	82.59%
COMMODITIES	381,093.00	(21,441.00)	359,652.00	319,085.00	88.72%
UTILITIES	343,296.00	40,223.00	383,519.00	364,426.00	95.02%
PERIODIC/ ROUTINE MAINTENANCE	79,500.00	(8,429.00)	71,071.00	59,173.00	83.26%
CAPITAL OUTLAY	12,350.00	0.00	12,350.00	12,100.00	97.98%
TRANSFERS TO OTHER FUNDS	190,600.00	0.00	190,600.00	190,600.00	100.00%
TOTAL FOR FUND 02 EXPENDITURES	<u>3,457,540.00</u>	<u>0.00</u>	<u>3,457,540.00</u>	<u>3,227,864.00</u>	<u>93.36%</u>
<b>Fund 03 - MUSEUM</b>					
SALARIES AND WAGES	951,973.00	6,780.00	958,752.00	937,653.00	97.80%
FRINGE BENEFITS	104,295.00	(2,250.00)	102,045.00	103,581.00	101.51%
CONTRACTUAL	810,641.00	4,140.00	814,781.00	740,787.00	90.92%
COMMODITIES	168,640.00	(12,124.00)	156,517.00	140,668.00	89.87%
UTILITIES	126,859.00	3,454.00	130,313.00	131,276.00	100.74%
PERIODIC/ ROUTINE MAINTENANCE	47,000.00	0.00	47,000.00	0.00	0.00%
TRANSFERS TO OTHER FUNDS	285,900.00	0.00	285,900.00	285,900.00	100.00%
TOTAL FOR FUND 03 EXPENDITURES	<u>2,495,308.00</u>	<u>0.00</u>	<u>2,495,308.00</u>	<u>2,339,865.00</u>	<u>93.77%</u>

41-1

SUMMARY OF BUDGET LINE TRANSFERS REPORT FOR CHAMPAIGN PARK DISTRICT  
 FYE2018 ORIGINAL BUDGET WITH BUDGET LINE TRANSFERS  
 MAY 1, 2017 THROUGH APRIL 30, 2018

Fund - Budget Category	ADOPTED BUDGET	NET TRANSFERS	FINAL AMENDED BUDGET	YTD ACTUAL	PCT OF BUDGET USED
<b>Fund 04 - LIABILITY INSURANCE</b>					
SALARIES AND WAGES	46,963.00	213.00	47,176.00	47,176.00	100.00%
FRINGE BENEFITS	9,179.00	22.00	9,201.00	9,201.00	100.00%
CONTRACTUAL	15,464.00	(235.00)	15,229.00	3,244.00	21.30%
COMMODITIES	6,210.00	0.00	6,210.00	3,377.00	54.38%
INSURANCE	239,210.00	0.00	239,210.00	237,021.00	99.08%
CAPITAL OUTLAY	60,000.00	0.00	60,000.00	23,913.00	39.86%
TOTAL FOR FUND 04 EXPENDITURES	<u>377,026.00</u>	<u>0.00</u>	<u>377,026.00</u>	<u>323,932.00</u>	<u>85.92%</u>
<b>Fund 11 - ACTIVITY AND AFFILIATES FUND</b>					
COMMODITIES	9,462.00	0.00	9,462.00	5,857.00	61.90%
TOTAL FOR FUND 11 EXPENDITURES	<u>9,462.00</u>	<u>0.00</u>	<u>9,462.00</u>	<u>5,962.00</u>	<u>63.01%</u>
<b>Fund 15 - SPECIAL RECREATION FUND</b>					
SALARIES AND WAGES	447,355.00	0.00	447,355.00	440,938.00	98.57%
FRINGE BENEFITS	81,137.00	0.00	81,137.00	74,048.00	91.26%
CONTRACTUAL	108,879.00	(472.00)	108,407.00	98,550.00	90.91%
COMMODITIES	39,004.00	(439.00)	38,565.00	31,142.00	80.75%
UTILITIES	5,599.00	24.00	5,623.00	5,029.00	89.44%
INSURANCE	8,878.00	887.00	9,765.00	9,764.00	99.99%
CAPITAL OUTLAY	715,000.00	0.00	715,000.00	378,506.00	52.94%
ADA-CUSR URBANA PARK DISTRICT	102,500.00	0.00	102,500.00	45,213.00	44.11%
TOTAL FOR FUND 15 EXPENDITURES	<u>1,508,352.00</u>	<u>0.00</u>	<u>1,508,352.00</u>	<u>1,083,190.00</u>	<u>71.81%</u>
<b>Fund 27 - HUMAN KINETICS PARK IMPROVEMENT FUND</b>					
CONTRACTUAL	101,200.00	0.00	101,200.00	97,317.00	96.16%
TOTAL FOR FUND 27 EXPENDITURES	<u>101,200.00</u>	<u>0.00</u>	<u>101,200.00</u>	<u>97,317.00</u>	<u>96.16%</u>

A1-2

Fund 01  
General

CHAMPAIGN PARK DISTRICT  
JOURNAL ENTRY  
JE: 3897

Entered By: andrea.wallace  
Journal: BA

Post Date: 04/30/2018  
Entry Date: 06/20/2018

Description: **FYE2018 FUND 01 BUDGET LINE TRANSFERS**  
FYE2018 BUDGET LINE TRANSFERS FOR LINE ITEMS THAT  
EXCEEDED BUDGET AND BALANCED OUT WITHIN FUND 01 -  
GENERAL. TOTALS TRANSFERRED BY DEPARTMENT AS  
FOLLOWS:

Total Fund 01 =  
\$112,660.07  
2.0% of operating  
budget

GENERAL FUND DEPARTMENTS:

ADMINISTRATION - \$62,464.45  
VOLUNTEERS - \$284.73  
SAFETY - \$150  
MARKETING - \$2,805.27  
OPERATIONS ADMINISTRATION - \$7,122.73  
OPERATIONS LANDSCAPE - \$7,320.21  
OPERATIONS FACILITIES - \$3,142.87  
OPERATIONS PARK MAINTENANCE - \$1,626.31  
OPERATIONS FLOWER ISLANDS - \$5,029.66  
OPERATIONS PARK FLOWERS - \$8,035.31  
OPERATIONS SPECIAL PROJECTS - \$9,940.02  
OPERATIONS NATURAL AREAS - \$4,715.54  
PLANNING - \$22.97

GENERAL FUND TOTAL TRANSFERS = \$112,660.07

GL #	Description	DR	CR
01-01-001-53132	ADMIN-DENTAL INSURANCE		348.63
01-01-001-53133	ADMIN-MEDICAL HEALTH INSURANCE	3,809.66	
01-01-001-53134	ADMIN-LIFE INSURANCE		607.57
01-01-001-53137	ADMIN-EMPLOYEE ASSISTANCE PROGRAM		17.86
01-01-001-54202	ADMIN-PRINTING AND DUPLICATING		1,182.02
01-01-001-54204	ADMIN-STAFF MEETINGS	946.62	
01-01-001-54205	ADMIN-LEGAL PUBLICATIONS/NOTICES		1,232.52
01-01-001-54206	ADMIN-ADVERTISING/PUBLICITY		763.38
01-01-001-54207	ADMIN-STAFF TRAINING	2,000.00	
01-01-001-54208	ADMIN-MEMBERSHIPS, DUES AND FEES		135.11
01-01-001-54210	ADMIN-BOARD EXPENSE	6,449.60	
01-01-001-54212	ADMIN-ATTORNEY FEES		30,624.83
01-01-001-54236	ADMIN-AUTO ALLOWANCE		50.00
01-01-001-54240	ADMIN-OFFICE EQUIPMENT REPAIRS	150.00	
01-01-001-54242	ADMIN-EQUIPMENT REPAIR	240.00	
01-01-001-54245	ADMIN-BUILDING REPAIR	100.00	
01-01-001-54250	ADMIN-EQUIPMENT RENTAL		403.50
01-01-001-54254	ADMIN-SERVICE CONTRACTS	4,570.00	
01-01-001-54255	ADMIN-LICENSE AND FEES		754.65
01-01-001-54265	ADMIN-SUBSCRIPTIONS	400.00	
01-01-001-54270	ADMIN-PERSONNEL COSTS		3,147.23
01-01-001-54275	ADMIN-HEALTH AND WELLNESS	2,422.57	
01-01-001-54281	ADMIN-CONTRACTUAL PERSONNEL	100.00	
01-01-001-55301	ADMIN-OFFICE SUPPLIES	2,924.17	
01-01-001-55302	ADMIN-ENVELOPES AND STATIONARY		839.84
01-01-001-55303	ADMIN-DUPLICATING SUPPLIES		187.10
01-01-001-55305	ADMIN-PHOTOGRAPHIC SUPPLIES	50.00	
01-01-001-55307	ADMIN-BOOKS AND MANUSCRIPTS		62.43
01-01-001-55315	ADMIN-STAFF UNIFORMS		3,886.73
01-01-001-55329	ADMIN-OFFICE/ EQUIPMENT VALUE <\$10000		736.98
01-01-001-55329-18NC02	ADMIN-OFFICE/ EQUIPMENT VALUE <\$10000		2,224.79
01-01-001-55329-18NC03	ADMIN-OFFICE/ EQUIPMENT VALUE <\$10000	2,210.00	
01-01-001-55348	ADMIN-FLOWERS AND CARDS		148.30
01-01-001-55349	ADMIN-PLAQUES, AWARDS AND PRIZES	339.39	
01-01-001-55350	ADMIN-RECREATION/PROGRAM SUPPLIES	1,772.20	
01-01-001-56231	ADMIN-GAS AND ELECTRICITY	3,173.20	
01-01-001-56233	ADMIN-TELECOMM EXPENSE		342.15
01-01-001-58002-18TECH	ADMIN-ROUTINE MAINTENANCE TECHNOLOGY		6,282.12

B1.1



Fund 01  
General  
202.74

01-01-001-59412	ADMIN-PROPERTY/SALES TAX		
01-01-001-59414	ADMIN-CREDIT CARD FEES	600.00	
01-01-001-70001	ADMIN-EXECUTIVE DIRECTOR		382.64
01-01-001-70101	ADMIN-DEPARTMENT HEAD		1,053.52
01-01-001-70301	ADMIN-OFFICE STAFF/SUPPORT		72.01
01-01-001-70501	ADMIN-MANAGERS/SUPERVISORS		1,358.37
01-01-001-70901	ADMIN-BUILDING SERVICE WORKER		216.81
01-01-001-80303	ADMIN-PT OFFICE STAFF/SUPPORT TECHNOLOGY		2,578.57
01-01-001-80903	ADMIN-PT BUILDING SERVICE WORKER		322.32
01-01-001-83003	ADMIN-ALLOWANCES/REIMBURSEMENTS		2,299.73
01-10-006-54202	VOLUNTEERS-PRINTING AND DUPLICATING	250.00	
01-10-006-54206	VOLUNTEERS-ADVERTISING/PUBLICITY	250.00	
01-10-006-54208	VOLUNTEERS-MEMBERSHIPS, DUES AND FEES	600.00	
01-10-006-54280	VOLUNTEERS-OTHER CONTRACTUAL SERVICES	450.00	
01-10-006-55316	VOLUNTEERS-PARTICIPANT UNIFORMS	2,129.50	
01-10-006-55349	VOLUNTEERS-PLAQUES, AWARDS AND PRIZES	2,524.00	
01-10-006-55350	VOLUNTEERS-RECREATION/PROGRAM SUPPLIES	250.00	
01-10-006-55354	VOLUNTEERS-FOOD SUPPLIES	200.00	
01-10-006-71001	VOLUNTEERS-PROGRAM/FACILITY DIR		284.73
01-10-069-54201	MARKETING-POSTAGE AND MAILING	265.00	
01-10-069-54202	MARKETING-PRINTING AND DUPLICATING	6,018.07	
01-10-069-54204	MARKETING-STAFF MEETINGS	72.76	
01-10-069-54206	MARKETING-ADVERTISING/PUBLICITY		752.98
01-10-069-54207	MARKETING-STAFF TRAINING	846.00	
01-10-069-54209	MARKETING-CONFERENCE AND TRAVEL	342.38	
01-10-069-54215	MARKETING-PROFESSIONAL FEES	13,055.20	
01-10-069-54250	MARKETING-EQUIPMENT RENTAL	500.00	
01-10-069-54255	MARKETING-LICENSE AND FEES		359.88
01-10-069-54282	MARKETING-INTERN STIPEND	1,200.00	
01-10-069-54285	MARKETING-CONTRACTUAL ENTERTAINMENT	500.00	
01-10-069-55301	MARKETING-OFFICE SUPPLIES	1,888.19	
01-10-069-55302	MARKETING-ENVELOPES AND STATIONARY	500.00	
01-10-069-55349	MARKETING-PLAQUES, AWARDS AND PRIZES	4,106.35	
01-10-069-55350	MARKETING-RECREATION/PROGRAM SUPPLIES		1,335.06
01-10-069-55354	MARKETING-FOOD SUPPLIES	545.11	
01-10-069-70101	MARKETING-DEPARTMENT HEAD		255.03
01-10-069-70301	MARKETING-OFFICE STAFF/SUPPORT		98.83
01-10-069-80303	MARKETING-PT OFFICE STAFF/SUPPORT VACANT	16,022.48	
01-10-069-83003	MARKETING-ALLOWANCES/REIMBURSEMENTS		3.49
01-20-001-54201	OPS ADMIN-POSTAGE AND MAILING		63.28
01-20-001-54264	OPS ADMIN-CELL PHONE EXPENSE		1,246.00
01-20-001-54280	OPS ADMIN-OTHER CONTRACTUAL SERVICES	3,000.00	
01-20-001-55301	OPS ADMIN-OFFICE SUPPLIES		1,613.52
01-20-001-56230	OPS ADMIN-SANITARY FEES AND CHARGES		751.98
01-20-001-56231	OPS ADMIN-GAS AND ELECTRICITY		522.18
01-20-001-56232	OPS ADMIN-WATER		1,078.77
01-20-001-58001-18PM02	OPS ADMIN-PERIODIC MAINTENANCE		1,847.00
01-20-001-58001-18PM03	OPS ADMIN-PERIODIC MAINTENANCE	2,992.00	
01-20-070-54207	SAFETY -STAFF TRAINING		150.00
01-20-071-54255	OPS-LANDSCAPE MTC-LICENSE AND FEES		229.00
01-20-071-55315	OPS-LANDSCAPE MTC-STAFF UNIFORMS		49.84
01-20-071-70501	OPS-LANDSCAPE MTC-MANAGERS/SUPERVISORS		361.74
01-20-071-82703	OPS-LANDSCAPE MTC-PT SEASONAL STAFF		6,679.63
01-20-072-54234	OPS-FACILITIES/EQP-LANDFILL FEES		1,404.71
01-20-072-54260	OPS-FACILITIESERVICE CONTRACTS-FACILITIES		391.00
01-20-072-55315	OPS-FACILITIES/EQP-STAFF UNIFORMS		64.14
01-20-072-56230	OPS-FACILITIES/SANITARY FEES AND CHARGES		356.84
01-20-072-70501	OPS-FACILITIES/EQP-MANAGERS/SUPERVISORS		358.64
01-20-072-83003	OPS-FACILITIES/ALLOWANCES/REIMBURSEMENTS		567.54
01-20-073-54250	OPS-PARK MAINTENANCE-EQUIPMENT RENTAL		389.43
01-20-073-56230	OPS-PARK MAINTESANITARY FEES AND CHARGES	9.84	
01-20-073-56231	OPS-PARK MAINTENANCE-GAS AND ELECTRICITY	607.70	
01-20-073-70601	OPS-PARK MAINTENANCE-OPERATIONS STAFF		1,236.88
01-20-073-82703	OPS-PARK MAINTENANCE-PT SEASONAL STAFF	1,469.95	
01-20-074-54206	OPS FLOWER ISLANDS-ADVERTISING/PUBLICITY	47.00	
01-20-074-54234	OPS FLOWER ISLANDS-LANDFILL FEES		47.00
01-20-074-54241	OPS FLOWER ISLANDS-VEHICLE REPAIR	500.00	
01-20-074-54253	OPS FLOWER ISLANDS-PEST CONTROL	100.00	
01-20-074-54261	OPS FLOWER ISLASERVICE CONTRACTS-GROUNDS	288.00	
01-20-074-55301	OPS FLOWER ISLANDS-OFFICE SUPPLIES		37.39
01-20-074-55315	OPS FLOWER ISLANDS-STAFF UNIFORMS		276.00

B1.2

01-20-074-55321	OPS FLOWER ISLANDS-LANDSCAPE SUPPLIES		1,083.54
01-20-074-55327	OPS FLOWERVEHICLE/EQUIPMENT REPAIR PARTS		2,025.94
01-20-074-55330	OPS FLOWER ISLANDGAS, FUEL, GREASE AND OIL	1,034.85	
01-20-074-55331	OPS FLOWER ISLANDS-CHEMICALS	808.56	
01-20-074-56232	OPS FLOWER ISLANDS-WATER		1,123.51
01-20-074-70501	OPS FLOWER ISLANDS-MANAGERS/SUPERVISORS		125.32
01-20-074-70601	OPS FLOWER ISLANDS-OPERATIONS STAFF		238.36
01-20-074-82704	OPS FLOWER ISLANDS-PT SEASONAL		72.60
01-20-075-54207	OPS PARK FLOWERS-STAFF TRAINING		875.00
01-20-075-54241	OPS PARK FLOWERS-VEHICLE REPAIR	1,000.00	
01-20-075-54253	OPS PARK FLOWERS-PEST CONTROL	150.00	
01-20-075-54255	OPS PARK FLOWERS-LICENSE AND FEES		130.00
01-20-075-54261	OPS PARK FLOWERSERVICE CONTRACTS-GROUNDS	588.00	
01-20-075-55301	OPS PARK FLOWERS-OFFICE SUPPLIES	130.18	
01-20-075-55307	OPS PARK FLOWERS-BOOKS AND MANUSCRIPTS	75.00	
01-20-075-55315	OPS PARK FLOWERS-STAFF UNIFORMS		504.60
01-20-075-55321	OPS PARK FLOWERS-LANDSCAPE SUPPLIES		633.72
01-20-075-55325	OPS PARK FLOWERS-EQUIPMENT AND TOOLS		506.06
01-20-075-55327	OPS PARK FLOWERS-VEH/EQUIP REPAIR PARTS		2,080.32
01-20-075-55330	OPS PARK FLOWERS-GAS, FUEL, GREASE AND OIL	1,504.67	
01-20-075-55331	OPS PARK FLOWERS-CHEMICALS	1,349.43	
01-20-075-55333	OPS PARK FLOWERS-PLANT MATERIALS	5,524.70	
01-20-075-70501	OPS PARK FLOWERS-MANAGERS/SUPERVISORS		187.62
01-20-075-70601	OPS PARK FLOWERS-OPERATIONS STAFF		643.27
01-20-075-82703	OPS PARK FLOWERS-PT SEASONAL STAFF		2,474.72
01-20-079-54207	OPS SPECIAL PROJECTS-STAFF TRAINING		133.00
01-20-079-54242	OPS SPECIAL PROJECTS-EQUIPMENT REPAIR	300.00	
01-20-079-54245	OPS SPECIAL PROJECTS-BUILDING REPAIR	500.00	
01-20-079-54250	OPS SPECIAL PROJECTS-EQUIPMENT RENTAL	871.00	
01-20-079-54255	OPS SPECIAL PROJECTS-LICENSE AND FEES		70.00
01-20-079-55315	OPS SPECIAL PROJECTS-STAFF UNIFORMS		258.17
01-20-079-55331	OPS SPECIAL PROJECTS-CHEMICALS		418.30
01-20-079-55332	OPS SPECIAL PROJECTS-PAINTS	492.81	
01-20-079-70501	OPS SPECIAL PROJECTS-MANAGERS/SUPERVISOR		122.22
01-20-079-70601	OPS SPECIAL PROJECTS-OPERATIONS STAFF		560.84
01-20-079-82703	OPS SPECIAL PROJECTS-PT SEASONAL STAFF		8,377.49
01-20-080-54207	OPS NATURAL AREAS-STAFF TRAINING	205.00	
01-20-080-54208	OPS NATURAL AREAS-MEMBERSHIPS, DUES&FEES		500.00
01-20-080-54209	OPS NATURAL AREAS-CONFERENCE AND TRAVEL	450.00	
01-20-080-54234	OPS NATURAL AREAS-LANDFILL FEES		45.00
01-20-080-54241	OPS NATURAL AREAS-VEHICLE REPAIR	250.00	
01-20-080-54242	OPS NATURAL AREAS-EQUIPMENT REPAIR	225.00	
01-20-080-54255	OPS NATURAL AREAS-LICENSE AND FEES	130.00	
01-20-080-55301	OPS NATURAL AREAS-OFFICE SUPPLIES	80.00	
01-20-080-55307	OPS NATURAL AREAS-BOOKS AND MANUSCRIPTS	200.00	
01-20-080-55315	OPS NATURAL AREAS-STAFF UNIFORMS		490.46
01-20-080-55321	OPS NATURAL AREAS-LANDSCAPE SUPPLIES		457.46
01-20-080-55324	OPS NATURAL AREAPRESCRIBED BURN SUPPLIES		61.87
01-20-080-55325	OPS NATURAL AREAS-EQUIPMENT AND TOOLS		131.63
01-20-080-55327	OPS NATURAL AREAS-VEH/EQUIP REPAIR PARTS	245.48	
01-20-080-55330	OPS NATURAL AREAS-GAS, FUEL, GREASE & OIL	658.15	
01-20-080-55333	OPS NATURAL AREAS-PLANT MATERIALS	1,974.55	
01-20-080-70501	OPS NATURAL AREAS-MANAGERS/SUPERVISORS		10.67
01-20-080-82703	OPS NATURAL AREAS-PT SEASONAL STAFF		3,018.45
01-20-080-83003	OPS NATURAL AREAS-ALLOWANCES/REIMB	125.75	
01-20-300-54201	PLANNING-POSTAGE AND MAILING		22.97

Journal Total:	112,660.07	112,660.07
----------------	------------	------------

APPROVED BY: \_\_\_\_\_

CHAMPAIGN PARK DISTRICT  
JOURNAL ENTRY  
JE: 3901

Total Fund 2 Recreation  
\$174,501.53  
5% of operating budget  
Entered By: andrea.wallace  
Journal: BA

Post Date: 04/30/2018  
Entry Date: 06/21/2018  
Description: FYE2018 FUND 2 **BUDGET LINE TRANSFERS**  
**FYE2018 FUND 02 RECREATION** PARTIAL BUDGET LINE  
TRANSFERS FOR ADMINISTRATION TOTALING \$7,800.80

GL #	Description	DR	CR
02-01-001-54207	REC ADMIN - STAFF TRAINING		558.50
02-01-001-54215	REC ADMIN - PROFESSIONAL FEES	2,352.13	
02-01-001-54241	REC ADMIN - VEHICLE REPAIR		1,948.60
02-01-001-54264	REC ADMIN - CELL PHONE EXPENSE		11.72
02-01-001-54280	REC ADMIN - OTHER CONTRACTUAL SERVICES	2,000.00	
02-01-001-54282	REC ADMIN - INTERN STIPEND		100.00
02-01-001-55303	REC ADMIN - DUPLICATING SUPPLIES	300.00	
02-01-001-55305	REC ADMIN - PHOTOGRAPHIC SUPPLIES	150.00	
02-01-001-55315	REC ADMIN - STAFF UNIFORMS	200.00	
02-01-001-55327	REC ADMIN - VEHICLE/EQUIP REPAIR PARTS		3.67
02-01-001-55329-18NC05	REC ADMIN - OFFICE/ EQUIP VALUE <\$10000	1,798.67	
02-01-001-55350	REC ADMIN - RECREATION/PROGRAM SUPPLIES	1,000.00	
02-01-001-59414	REC ADMIN - CREDIT CARD FEES		5,178.31
Journal Total:		7,800.80	7,800.80

APPROVED BY: \_\_\_\_\_

B1.4



Fund 2 - Recreation

CHAMPAIGN PARK DISTRICT  
JOURNAL ENTRY  
JE: 3902

Entered By: andrea.wallace  
Journal: BA

Post Date: 04/30/2018

Entry Date: 06/21/2018

Description: **FYE2018 FUND 2 BUDGET LINE TRANSFERS**

FYE2018 BUDGET LINE TRANSFER FOR RECREATION FUND 02

TOTALS BY DEPARTMENT AS FOLLOWS:

REC ADMINISTRATION - \$6,191.84 (CUMULATIVE TOTAL  
POSTED FOR REC ADMIN IS \$13,992.64)  
FACILITIES - DOUGLASS ANNEX - \$1,551.24  
FACILITIES - HAYS CENTER - \$2,522.00  
FACILITIES - BALLFIELD MAINTENANCE - \$26,110.01

GL #	Description	DR	CR
02-01-001-53134	REC ADMIN - LIFE INSURANCE		18.02
02-01-001-53137	REC ADMIN - EMPLOYEE ASSISTANCE PROGRAM	18.02	
02-01-001-54205	REC ADMIN - LEGAL PUBLICATIONS/NOTICES	83.19	
02-01-001-54208	REC ADMIN - MEMBERSHIPS, DUES AND FEES	143.50	
02-01-001-54209	REC ADMIN - CONFERENCE AND TRAVEL	2,876.18	
02-01-001-54265	REC ADMIN - SUBSCRIPTIONS	150.00	
02-01-001-55302	REC ADMIN - ENVELOPES AND STATIONARY	200.00	
02-01-001-55330	REC ADMIN - FUEL PURCHASES	855.95	
02-01-001-55354	REC ADMIN - FOOD SUPPLIES	500.00	
02-01-001-70101	REC ADMIN - DEPARTMENT HEAD		191.84
02-01-001-70301	REC ADMIN - OFFICE STAFF		1,103.16
02-01-001-70501	REC ADMIN - MANAGERS/SUPERVISORS		141.89
02-01-001-81503	REC ADMIN - PT GENERAL STAFF	1,365.00	
02-01-001-83003	REC ADMIN - ALLOWANCES/REIMBURSEMENTS		4,736.93
02-30-020-54207	REC DOUGLASS ANNEX - STAFF TRAINING	412.00	
02-30-020-54245	REC DOUGLASS ANNEX - BUILDING REPAIR	500.00	
02-30-020-54254	REC DOUGLASS ANNEX - SERVICE CONTRACTS		8.00
02-30-020-54260	REC DOUGLASS ANNEX -SVC CONTR-FACILITIES	647.24	
02-30-020-55301	REC DOUGLASS ANNEX - OFFICE SUPPLIES		125.90
02-30-020-55320	REC DOUGLASS ANNEX - BLDG MAINT SUPPLIES		1,005.77
02-30-020-55322	REC DOUGLASS ANNEX - JANITORIAL SUPPLIES		330.33
02-30-020-56233	REC DOUGLASS ANNEX - TELECOMM EXPENSE		89.24
02-30-021-54242	REC HAYS CTR -EQUIPMENT REPAIR	500.00	
02-30-021-54245	REC HAYS CTR -BUILDING REPAIR	683.54	
02-30-021-55303	REC HAYS CENTER - DUPLICATING SUPPLIES		79.96
02-30-021-58001-18PM04	REC HAYS CTR -PERIODIC MAINTENANCE	1,338.46	
02-30-021-80903	REC HAYS CTR -PT BUILDING SERVICE WORKER		263.86
02-30-021-81903	REC HAYS CTR -PT BUILDING/PARK OPENERS		2,178.18
02-30-076-55315	BALLFIELD MTC -STAFF UNIFORMS		74.42
02-30-076-55330	BALLFIELD MTC - -GAS, FUEL, GREASE & OIL		1,259.95
02-30-076-55332	BALLFIELD MAINTENANCE PAINTS	2,444.26	
02-30-076-55333	BALLFIELD MAINTENANCE PLANT MATERIALS	945.45	
02-30-076-56232	BALLFIELD MAINTENANCE -WATER		24,654.95
02-30-076-70501	BALLFIELD MAINTENANCE - MGR./SUPV.		120.69
02-30-076-82703	BALLFIELD MAINTENANCE -PT SEASONAL STAFF	22,720.30	
Journal Total:		36,383.09	36,383.09

APPROVED BY: \_\_\_\_\_

B1.5

CHAMPAIGN PARK DISTRICT

JOURNAL ENTRY

JE: 3903

Post Date: 04/30/2018

Entered By: andrea.wallace

Entry Date: 06/21/2018

Journal: BA

Description: **FYE2018 FUND 2 BUDGET LINE TRANSFERS**

FYE2018 BUDGET LINE TRANSFER FOR RECREATION FUND 02

TOTALS BY DEPARTMENT AS FOLLOWS:

- FACILITIES - DOUGLASS COMMUNITY CENTER \$2,246.15
- FACILITIES - KAUFMAN LAKE - \$565.65
- FACILITIES - DOG PARK - \$9.42
- FACILITIES - LEONHARD RECREATION CENTER - \$16,730.97

GL #	Description	DR	CR
02-30-092-56233	REC DOUGLASS CTR - TELECOMM EXPENSE		32.89
02-30-092-70301	REC DOUGLASS CTR -OFFICE STAFF/SUPPORT		152.12
02-30-092-70501	REC DOUGLASS CTR -MANAGERS/SUPERVISORS	1,057.46	
02-30-092-71001	REC DOUGLASS CTR -PROGRAM/FACILITY DIR.		1,365.38
02-30-092-80303	REC DOUGLASS CTR-PT OFFICE STAFF/SUPPORT	1,188.69	
02-30-092-81503	REC DOUGLASS CTR -PT GENERAL STAFF		169.46
02-30-092-81803	REC DOUGLASS CTR -PT SITE SUPERVISOR		526.30
02-30-094-54260	REC KAUFMAN LK -SVC CONTRACTS-FACILITIES		27.50
02-30-094-56230	REC KAUFMAN LK -SANITARY FEES & CHARGES		76.07
02-30-094-56232	REC KAUFMAN LK - WATER		28.50
02-30-094-71001	REC KAUFMAN LK -PROGRAM/FACILITY DIR		142.44
02-30-094-81503	REC KAUFMAN LK PT GENERAL STAFF		291.14
02-30-155-54245	REC DOG PARK - BUILDING REPAIR	565.65	
02-30-155-55320	REC DOG PARK - BLDG MAINTENANCE SUPPLIES	996.26	
02-30-155-56232	WATER	868.24	
02-30-155-71001	REC DOG PARK - PROGRAM/FACILITY DIR		9.42
02-30-160-54204	STAFF MEETINGS	50.00	
02-30-160-54242	REC LEONHARD CTR - EQUIPMENT REPAIR	483.47	
02-30-160-54245	REC LEONHARD REC CTR - BUILDING REPAIR		2,553.96
02-30-160-54254	REC LEONHARD CTR - SERVICE CONTRACTS	3,600.24	
02-30-160-54260	REC LEONHARD CTR - SVC CONTR-FACILITIES		1,536.01
02-30-160-55301	REC LEONHARD CTR - OFFICE SUPPLIES		36.20
02-30-160-55303	REC LEONHARD CTR - DUPLICATING SUPPLIES	342.30	
02-30-160-55320	REC LEONHARD CTR - BLDG MTC SUPPLIES	1,502.38	
02-30-160-55322	REC LEONHARD CTR - JANITORIAL SUPPLIES	120.00	
02-30-160-55350	REC LEONHARD CTR - REC/PRG SUPPLIES	1,054.38	
02-30-160-56231	REC LEONHARD CTR - GAS AND ELECTRICITY		2,977.92
02-30-160-56232	REC LEONHARD CTR - WATER		337.72
02-30-160-70301	REC LEONHARD CTR - OFFICE STAFF/SUPPORT	6,940.16	
02-30-160-70501	REC LEONHARD CTR - MANAGERS/SUPERVISORS		1,082.68
02-30-160-70901	REC LEONHARD CTR - CUSTODIAL		530.46
02-30-160-71001	REC LEONHARD CTR - PROGRAM/FACILITY DIR		294.78
02-30-160-80303	REC LEONHARD CTR PT OFFICE STAFF/SUPPORT		7,328.69
02-30-160-80903	REC LEONHARD CTR - PT CUSTODIAL	782.96	
02-30-160-81803	REC LEONHARD CTR - PT SITE SUPERVISOR		52.55
Journal Total:		19,552.19	19,552.19

APPROVED BY: \_\_\_\_\_



CHAMPAIGN PARK DISTRICT  
 JOURNAL ENTRY  
 JE: 3904

Entered By: andrea.wallace  
 Journal: BA

Post Date: 04/30/2018  
 Entry Date: 06/22/2018

Description: **FYE2018 FUND 2 BUDGET LINE TRANSFERS**  
 FYE2018 BUDGET LINE TRANSFER FOR RECREATION FUND 02  
 TOTALS BY DEPARTMENT AS FOLLOWS:

- SPORTS - DODDS TENNIS CENTER - \$1,891.34
- SPORTS - FITNESS EVENTS - \$1,999.56
- SPORTS - ADULT SOFTBALL- \$3,830.70
- SPORTS - ADULT VOLLEYBALL - \$464.00
- SPORTS - YOUTH BASKETBALL - \$4,298.86
- SPORTS - YOUTH SOFTBALL - \$237.50
- SPORTS - YOUTH SOCCER - \$1,819.87

GL #	Description	DR	CR
02-01-001-53133	MEDICAL HEALTH INSURANCE	3,996.65	
02-40-025-54234	REC DODDS TENNIS CTR-LANDFILL FEES		51.46
02-40-025-54260	REC DODDS TENNIS -SVC CONTR-FACILITIES	1,891.34	
02-40-025-55320	REC DODDS TENNIS CTR-BLDG MTC SUPPLIES		58.98
02-40-025-55354	REC DODDS TENNIS CTR-FOOD SUPPLIES		29.60
02-40-025-55360	REC DODDS TENNIS -MERCHANDISE FOR RESALE		330.28
02-40-025-56232	REC DODDS TENNIS CTR-WATER		103.08
02-40-025-56233	REC DODDS TENNIS CTR-TELECOMM EXPENSE		760.64
02-40-025-59412	REC DODDS TENNIS CTR-PROPERTY/SALES TAX		98.00
02-40-025-71001	REC DODDS TENNIS -PRG /FACILITY DIRECTOR		411.08
02-40-025-83003	REC DODDS TENNIS CTR-ALLOWANCES		48.22
02-40-065-54202	REC-FITNESS EVENT PRINTING & DUPLICATING	166.97	
02-40-065-54250	REC-FITNESS EVENTS -EQUIPMENT RENTAL	100.00	
02-40-065-54280	OTHER CONTRACTUAL SERVICES	300.00	
02-40-065-55316	REC-FITNESS EVENTS -PARTICIPANT UNIFORMS		814.00
02-40-065-55350	REC-FITNESS EVENTS -RECR/PRG SUPPLIES		245.34
02-40-065-55354	REC-FITNESS EVENTS -FOOD SUPPLIES		341.89
02-40-065-71001	REC-FITNESS EVENTS -PROGRAM/FACILITY DIR		598.33
02-40-082-54208	ADULT SOFTBALL -MEMBERSHIPS, DUES & FEES		140.98
02-40-082-54264	ADULT SOFTBALL -CELL PHONE EXPENSE		248.50
02-40-082-54281	ADULT SOFTBALL -CONTRACTUAL PERSONNEL		2,820.00
02-40-082-55315	ADULT SOFTBALL -STAFF UNIFORMS		59.63
02-40-082-55322	ADULT SOFTBALL -JANITORIAL SUPPLIES	110.40	
02-40-082-55349	ADULT SOFTBALL -PLAQUES/AWARDS/PRIZES	171.35	
02-40-082-55350	ADULT SOFTBALL -REC /PROGRAM SUPPLIES		58.61
02-40-082-71001	ADULT SOFTBALL -PROGRAM/FACILITY DIR.		82.62
02-40-082-81003	ADULT SOFTBALL -PT PRG DIR/SUPERVISOR		420.36
02-40-082-81103	ADULT SOFTBALL -PT SPORTS OFFICIAL	3,548.95	
02-40-083-54208	ADULT VOLLEYBALL MEMBERSHIPS, DUES& FEES		29.00
02-40-083-54281	CONTRACTUAL PERSONNEL	464.00	
02-40-083-81103	ADULT SOFTBALL -PT SPORTS OFFICIAL		435.00
02-40-085-54281	YOUTH BASKETBALL -CONTRACTUAL PERSONNEL	1,070.00	
02-40-085-55316	YOUTH BASKETBALL -PARTICIPANT UNIFORMS	664.80	
02-40-085-71001	YOUTH BASKETBALL -PROGRAM/FACILITY DIR		31.72
02-40-085-81003	YOUTH BASKETBALL - PRG DIR/SUPERVISOR		595.62
02-40-085-81103	YOUTH SOFTBALL - PT SPORTS OFFICIAL		3,671.52
02-40-086-54206	YOUTH SOFTBALL - ADVERTISING/PUBLICITY		40.00
02-40-086-55316	YOUTH SOFTBALL - PARTICIPANT UNIFORMS		197.50
02-40-086-81003	YOUTH SOFTBALL - PT PRG DIR/SPVR	237.50	
02-40-088-54202	YOUTH SOCCER - PRINTING AND DUPLICATING		25.32
02-40-088-54208	YOUTH SOCCER -MEMBERSHIPS, DUES AND FEES	78.72	
02-40-088-54250	YOUTH SOCCER - EQUIPMENT RENTAL	170.00	
02-40-088-54281	YOUTH SOCCER - CONTRACTUAL PERSONNEL		1,660.00
02-40-088-55315	YOUTH SOCCER - STAFF UNIFORMS		12.98
02-40-088-55316	YOUTH SOCCER - PARTICIPANT UNIFORMS	1,571.15	
02-40-088-71001	YOUTH SOCCER - PROGRAM/FACILITY DIR		63.25
02-40-088-81403	YOUTH SOCCER - PT INSTRUCTOR		58.32
Journal Total:		14,541.83	14,541.83

APPROVED BY: \_\_\_\_\_

B1.7

Fund 2

CHAMPAIGN PARK DISTRICT

JOURNAL ENTRY

JE: .3906

Post Date: 04/30/2018

Entered By: andrea.wallace

Entry Date: 06/22/2018

Journal: BA

Description: FYE2018 FUND 2 BUDGET LINE TRANSFERS

FYE2018 BUDGET LINE TRANSFER FOR RECREATION FUND 02

TOTALS BY DEPARTMENT AS FOLLOWS:

- SPORTS - GROUP FITNESS - \$1,47.33
- SPORTS - MOTOR SKILLS DEVELOPMENT - \$90.66
- SPORTS - SPORT CAMPS - \$235.20
- SPORTS - DODDS SOCCER - \$103.47
- SPORTS - BALLFIELD RENTALS - \$500.52
- SPORTS - YOUTH VOLLEYBALL - \$173.75
- SPORTS - ADULT SOCCER - \$3,467.48
- SPORTS - DOUGLASS YOUTH - \$1,986.92

GL #	Description	DR	CR
02-40-150-54281	GROUP FITNESS - CONTRACTUAL PERSONNEL		1,239.00
02-40-150-71001	GROUP FITNESS - PROGRAM/FACILITY DIR		8.33
02-40-150-81403	GROUP FITNESS - PT INSTRUCTOR	1,247.33	
02-40-195-54202	MOTOR SKILLS DEV - PRINTING/DISTRIBUTION	90.66	
02-40-195-71001	MOTOR SKILLS DEV - PROGRAM/FACILITY DIR		90.66
02-40-196-54206	SPORT CAMPS - ADVERTISING/PUBLICITY	95.20	
02-40-196-54281	SPORT CAMPS - CONTRACTUAL PERSONNEL		235.20
02-40-196-55316	SPORT CAMPS - PARTICIPANT UNIFORMS	140.00	
02-40-197-54250	DODDS SOCCER - EQUIPMENT RENTAL	74.34	
02-40-197-55322	DODDS SOCCER - JANITORIAL SUPPLIES		103.47
02-40-197-81803	DODDS SOCCER - PT SITE SUPERVISOR	181.25	
02-40-198-55322	BALLFIELD RENTALS -JANITORIAL SUPPLIES	3.74	
02-40-198-55350	BALLFIELD RENTALS -RECR/PRG SUPPLIES	419.00	
02-40-198-71001	BALLFIELD RENTALS -PROGRAM/FACILITY DIR.		58.29
02-40-198-82703	BALLFIELD RENTALS -PT SEASONAL STAFF		442.23
02-40-200-54206	YOUTH VOLLEYBALL - ADVERTISING/PUBLICITY	99.41	
02-40-200-81103	YOUTH VOLLEYBALL - PT SPORTS OFFICIAL		115.50
02-40-200-81403	YOUTH VOLLEYBALL - PT INSTRUCTOR		58.25
02-40-202-54208	ADULT SOCCER - MEMBERSHIPS, DUES & FEES		84.02
02-40-202-54281	ADULT SOCCER - CONTRACTUAL PERSONNEL		3,317.50
02-40-202-55349	ADULT SOCCER - PLAQUES, AWARDS, & PRIZES		15.75
02-40-202-71001	ADULT SOCCER - PROGRAM/FACILITY DIR.		50.21
02-40-202-81103	ADULT SOCCER - PT SPORTS OFFICIAL	3,467.48	
02-40-203-54208	DOUGLASS YOUTH - MEMBERSHIPS DUES & FEES		65.00
02-40-203-54280	DOUGLASS YOUTH - OTHER CONTRL SERVICES	1,000.00	
02-40-203-54281	DOUGLASS YOUTH - OTHER CONTR PERSONNEL	886.92	
02-40-203-54299	DOUGLASS YOUTH - FIELD/SPECIAL TRIPS		1,053.47
02-40-203-55307	DOUGLASS YOUTH - BOOKS AND MANUSCRIPTS	100.00	
02-40-203-55316	DOUGLASS YOUTH - PARTICIPANT UNIFORMS		190.76
02-40-203-55349	DOUGLASS YOUTH - PLAQUES, AWARDS, PRIZES		7.69
02-40-203-55354	DOUGLASS YOUTH - FOOD SUPPLIES		324.58
02-40-203-55360	DOUGLASS YOUTH - MERCHANDISE FOR RESALE		345.42
Journal Total:		7,805.33	7,805.33

APPROVED BY: \_\_\_\_\_

B1.8



CHAMPAIGN PARK DISTRICT

JOURNAL ENTRY

JE: 3907

Post Date: 04/30/2018

Entered By: andrea.wallace

Entry Date: 06/22/2018

Journal: BA

Description: **FYE2018 FUND 2 BUDGET LINE TRANSFERS**

FYE2018 BUDGET LINE TRANSFER FOR RECREATION FUND 02

TOTALS BY DEPARTMENT AS FOLLOWS:

- DAYCAMPS / AFTERSCHOOL GIRLS EXPLORE - \$5,476.03
- DAYCAMPS / AFTERSCHOOL DOUGLASS TEEN CAMP - \$820.15
- DAYCAMPS / AFTERSCHOOL BUSY BEES - \$5,488.99
- DAYCAMPS / AFTERSCHOOL LEONHARD DAYCAMP - \$8,571.17
- DAYCAMPS / AFTERSCHOOL DOUGLASS DAYCAMP - \$107.60
- DAYCAMPS / AFTERSCHOOL DOUGLASS COMMUNITY MATTERS \$323.65
- OTHER PROGRAMS SOLEM SWIM TEAM - \$486.36
- OTHER PROGRAMS DOUGLASS SENIORS - \$1,314.72
- OTHER PROGRAMS HAYS SENIORS - \$870.94
- OTHER PROGRAMS SCHOOL DAYS OUT - \$61.21
- TEENS IN ACTION - \$491.55
- DOUGLASS SPECIAL EVENTS - \$436.06
- CONCESSIONS SOLEM AQUATIC CENTER - \$10,239.53
- CONCESSIONS ZAHND - \$1,692.55
- CONCESSIONS DODDS PARK - \$7,325.02
- CONCESSIONS DODDS SOCCER \$7.97
- SOLEM AQUATIC CENTER - \$43,096.03

GL #	Description	DR	CR
02-50-004-81003	DOUGLASS CAMP - PT PRG DIR/SUPERVISOR	2,657.11	
02-50-004-81703	DOUGLASS CAMP - PT DAY CAMP STAFF	6,145.34	
02-50-005-54264	GIRLS EXPLORE - CELL PHONE EXPENSE		73.25
02-50-005-81303	GIRLS EXPLORE - PT ASST DIR/SUPERVISOR		3,153.75
02-50-005-81703	GIRLS EXPLORE - PT DAY CAMP STAFF		2,249.03
02-50-006-81703	DOUGLASS YOUTH CAMP - PT DAY CAMP STAFF	493.15	
02-50-009-54202	TEEN CAMP - PRINTING AND DUPLICATING	127.00	
02-50-009-54207	TEEN CAMP - STAFF TRAINING		19.55
02-50-009-54250	TEEN CAMP - EQUIPMENT RENTALS	100.00	
02-50-009-54264	TEEN CAMP - CELL PHONE EXPENSE		88.57
02-50-009-54280	TEEN CAMP - OTHER CONTRACTUAL SERVICES	100.00	
02-50-009-55316	TEEN CAMP - PARTICIPANT UNIFORMS		15.80
02-50-009-71001	TEEN CAMP - PROGRAM/FACILITY DIR.		245.76
02-50-009-81003	TEEN CAMP - PT PRG DIRECTOR/SUPERVISOR	1,843.83	
02-50-009-81303	TEEN CAMP - PT ASST DIR/SUPERVISOR		450.47
02-50-011-54206	BUSY BEES - ADVERTISING/PUBLICITY	300.00	
02-50-011-54299	BUSY BEES - FIELD/SPECIAL TRIPS	150.00	
02-50-011-55307	BUSY BEES - BOOKS AND MANUSCRIPTS	50.00	
02-50-011-55315	BUSY BEES - STAFF UNIFORMS	150.00	
02-50-011-55354	BUSY BEES - FOOD SUPPLIES	100.00	
02-50-011-71001	BUSY BEES - PROGRAM/FACILITY DIR.	2,895.16	
02-50-011-81403	BUSY BEES - PT INSTRUCTOR		5,488.99
02-50-012-54207	LEONHARD DAYCAMP - STAFF TRAINING	1,642.45	
02-50-012-54265	SUBSCRIPTIONS		182.70
02-50-012-54299	LEONHARD DAYCAMP - FIELD/SPECIAL TRIPS	3,602.30	
02-50-012-55315	STAFF UNIFORMS		201.80
02-50-012-55316	PARTICIPANT UNIFORMS		14.05
02-50-012-55350	LEONHARD DAYCAMP - REC/PROGRAM SUPPLIES		319.61
02-50-012-71001	LEONHARD DAYCAMP - PROGRAM/FACILITY DIR.		95.69
02-50-012-81003	LEONHARD DAYCAMP - PT PRG DIR/SUPERVISOR		3,000.68
02-50-012-81503	PT GENERAL STAFF		92.00
02-50-012-81703	LEONHARD DAYCAMP - PT DAY CAMP STAFF		4,664.64
02-50-013-55315	DOUGLASS DAYCAMP - STAFF UNIFORMS		107.60
02-50-013-55350	DOUGLASS DAYCAMP - REC/PROGRAM SUPPLIES	107.60	
02-50-013-81703	DOUGLASS DAYCAMP - PT DAY CAMP STAFF	4,827.85	
02-50-016-81003	COMMUNITY MATTERS -PT PRG DIR/SUPERVISOR	323.65	
02-50-016-81703	DAYCAMP-COMMUNITY MATTERS -PT CAMP STAFF		323.65
02-50-017-54265	LEONHARD CAMP - SUBSCRIPTIONS		72.45
02-50-017-55307	LEONHARD CAMP - BOOKS AND MANUSCRIPTS	300.00	

81.9

02-50-017-55350	LEONHARD CAMP - REC/PROGRAM SUPPLIES		20.23
02-50-017-71001	LEONHARD CAMP - PROGRAM/FACILITY DIR.		76.71
02-50-017-81003	LEONHARD CAMP - PT PRG DIR/SUPERVISOR		1,424.05
02-50-017-81703	LEONHARD CAMP - PT DAY CAMP STAFF	1,293.44	
02-60-026-54208	SHOLEM SWIM TEAM -MEMBERSHIPS, DUES FEES		88.00
02-60-026-55350	SHOLEM SWIM TEAM -REC/PROGRAM SUPPLIES		49.20
02-60-026-55354	SHOLEM SWIM TEAM -FOOD SUPPLIES		50.00
02-60-026-55360	SHOLEM SWIM TEAM -MERCHANDISE FOR RESALE	500.00	
02-60-026-71001	SHOLEM SWIM TEAM -PROGRAM/FACILITY DIR.		299.18
02-60-026-81003	PT PROGRAM DIRECTOR/SUPERVISOR		13.62
02-60-130-54236	DOUGLASS SENIORS - AUTO ALLOWANCE		247.70
02-60-130-54280	DOUGLASS SENIORS - OTHER CONTRACTUAL	128.66	
02-60-130-54281	DOUGLASS SENIORS - CONTRACTUAL PERSONNEL	1,314.72	
02-60-130-54299	DOUGLASS SENIORS - FIELD/SPECIAL TRIPS		1,067.02
02-60-130-81503	DOUGLASS SENIORS - PT GENERAL STAFF	507.28	
02-60-131-54206	HAYS SENIORS - ADVERTISING/PUBLICITY		125.00
02-60-131-54299	HAYS SENIORS - FIELD/SPECIAL TRIPS	125.00	
02-60-131-55315	HAYS SENIORS - STAFF UNIFORMS	50.00	
02-60-131-55348	HAYS SENIORS - FLOWERS AND GIFTS	60.00	
02-60-131-55350	HAYS SENIORS - REC/PROGRAM SUPPLIES		294.60
02-60-131-81503	HAYS SENIORS - PT GENERAL STAFF		451.34
02-60-241-55307	SCHOOL DAYS OUT - BOOKS AND MANUSCRIPTS	61.21	
02-60-241-55350	SCHOOL DAYS OUT - REC/PRG SUPPLIES		22.22
02-60-241-55354	SCHOOL DAYS OUT - FOOD SUPPLIES		1.60
02-60-241-71001	SCHOOL DAYS OUT - PROGRAM/FACILITY DIR.		37.39
02-65-123-71001	TEENS IN ACTION - PROGRAM/FACILITY DIR.		491.55
02-65-123-81503	TEENS IN ACTION - PT GENERAL STAFF	491.55	
02-68-092-54201	POSTAGE AND MAILING		1.68
02-68-092-71001	PROGRAM/FACILITY DIR.	437.74	
02-68-092-81503	DOUGLASS SPEC EVENTS - PT GENERAL STAFF		436.06
02-69-024-54255	CONCESSIONS POOL - LICENSE AND FEES	365.00	
02-69-024-55320	CONCESSIONS POOL - BLDG MTC SUPPLIES	100.00	
02-69-024-55322	CLEANING /JANITORIAL SUPPLIES	205.00	
02-69-024-55350	CONCESSIONS POOL - REC/PRG SUPPLIES	1,290.68	
02-69-024-55360	CONCESSIONS POOL -MERCHANDISE FOR RESALE		1,331.61
02-69-024-59412	CONCESSIONS POOL - PROPERTY/SALES TAX	451.00	
02-69-024-71001	CONCESSIONS POOL - PROGRAM/FACILITY DIR.		298.84
02-69-024-81003	CONCESSIONS POOL - PT PRG DIR/SPVSR	3,000.00	
02-69-024-81503	CONCESSIONS POOL - PT GENERAL STAFF		8,609.08
02-69-041-54245	BUILDING REPAIR	100.00	
02-69-041-54250	CONCESSIONS ZAHND - EQUIPMENT RENTAL	100.00	
02-69-041-54253	CONCESSIONS ZAHND - PEST CONTROL		60.00
02-69-041-54260	CONCESSIONS ZAHND - SERVICE CONTRACTS		32.25
02-69-041-55320	CONCESSIONS ZAHND - BLDG MTC SUPPLIES	200.00	
02-69-041-55322	CONCESSIONS ZAHND - ANITORIAL SUPPLIES	130.00	
02-69-041-55360	CONCESSIONS ZAHND MERCHANDISE FOR RESALE		1,417.14
02-69-041-56233	CONCESSIONS ZAHND - TELECOMM EXPENSE	156.82	
02-69-041-59412	CONCESSIONS ZAHND - PROPERTY/SALES TAX	334.00	
02-69-041-71001	CONCESSIONS ZAHND - PROGRAM/FACILITY DIR		7.78
02-69-041-81003	CONCESSIONS ZAHND - PT PRG DIR/SPVSR		99.54
02-69-041-81303	CONCESSIONS ZAHND - PT ASSS DIR/SPVSR	671.73	
02-69-041-81503	CONCESSIONS ZAHND - PT GENERAL STAFF		75.84
02-69-080-54242	CONCESSIONS DODDS - EQUIPMENT REPAIR	550.00	
02-69-080-54245	CONCESSIONS DODDS - BLDG REPAIR		419.75
02-69-080-54250	CONCESSIONS DODDS - EQUIPMENT RENTAL	150.00	
02-69-080-54260	CONCESSIONS DODDS - SERVICE CONTRACTS		35.75
02-69-080-54271	CONCESSIONS DODDS - PETTY CASH		600.00
02-69-080-55350	CONCESSIONS DODDS - REC/PRG SUPPLIES	350.00	
02-69-080-56230	CONCESSIONS DODDS - SANITARY FEES		646.66
02-69-080-59412	CONCESSIONS DODDS - PROPERTY/SALES TAX	513.00	
02-69-080-59414	CONCESSIONS DODDS - CREDIT CARD FEES		324.04
02-69-080-71001	CONCESSIONS DODDS -PROGRAM/FACILITY DIR.		58.22
02-69-080-81003	CONCESSIONS DODDS - PT PRG DIR/SPVSR		2,503.59
02-69-080-81303	CONCESSIONS DODDS - PT ASST DIR/SPVSR	5,762.02	
02-69-080-81503	CONCESSIONS DODDS - PT GENERAL STAFF		2,737.01
02-69-088-59412	CONCESSIONS SOCCER - PROPERTY/SALES TAX	7.97	
02-69-088-71001	CONCESSIONS SOCCER - PRG/FACILITY DIR		7.97
02-70-022-54202	PRINTING AND DUPLICATING		3.16
02-70-022-54204	SHOLEM AQUATICS - STAFF MEETINGS		15.31
02-70-022-54208	SHOLEM AQUATICS - MEMBERSHIPS, DUES FEES		419.00
02-70-022-54250	SHOLEM AQUATICS - EQUIPMENT RENTAL	45.76	



02-70-022-54251	SHOLEM AQUATICS - RENTAL FACILITIES		385.00
02-70-022-54265	SHOLEM AQUATICS - SUBSCRIPTIONS		264.00
02-70-022-55301	SHOLEM AQUATICS - OFFICE SUPPLIES	439.45	
02-70-022-55303	SHOLEM AQUATICS - DUPLICATING SUPPLIES		8.97
02-70-022-55308	SHOLEM AFIRST AID SUPPLIES-POOL SPECIFIC		612.21
02-70-022-55315	SHOLEM AQUATICS - STAFF UNIFORMS	3,599.60	
02-70-022-55320	SHOLEM AQUATICS - BLDG MTC SUPPLIES	6,824.59	
02-70-022-55350	SHOLEM AQUATICS - REC/PRG SUPPLIES	2,279.84	
02-70-022-55354	SHOLEM AQUATICS - FOOD SUPPLIES		423.56
02-70-022-56231	SHOLEM AQUATICS - GAS AND ELECTRICITY		7,815.13
02-70-022-56232	SHOLEM AQUATICS - WATER		3,700.17
02-70-022-56233	SHOLEM AQUATICS - TELECOMM EXPENSE		24.37
02-70-022-71001	SHOLEM AQUATICS - PROGRAM/FACILITY DIR.		4,829.18
02-70-022-81303	SHOLEM AQUATICS - PT ASST DIR/SPVSR		4,852.91
02-70-022-81403	SHOLEM AQUATICS - PT INSTRUCTOR		1,389.34
02-70-022-81503	SHOLEM AQUATICS - PT GENERAL STAFF	22,350.79	
02-70-022-81703	SHOLEM AQUATICS - PT LIFE GUARD		18,353.72
02-70-022-83003	SHOLEM AQUATICS - ALLOW/REIMBURSEMENTS	465.00	
02-70-022-58001	SHOLEM AQUATICS - PERIODIC MAINTENANCE	461.00	
02-70-022-58001	SHOLEM AQUATICS - PERIODIC MAINTENANCE	6,630.00	
	Journal Total:	88,418.29	88,418.29

APPROVED BY: \_\_\_\_\_

CHAMPAIGN PARK DISTRICT

JOURNAL ENTRY

JE: 3908

Post Date: 04/30/2018

Entered By: andrea.wallace

Entry Date: 06/22/2018

Journal: BA

Description: **FYE2018 FUND 3 BUDGET LINE TRANSFERS**

BUDGET LINE TRANSFERS FOR FUND 03 MUSEUM TOTALS  
TRANSFERRED BY DEPARTMENT IS AS FOLLOWS:

- MUSEUM ADMINISTRATION - \$14,414.70
- YOUTH THEATRE - \$2,344.87
- TASTE OF C-U = \$5,750.49
- SUMMER CONCERTS - \$797.36
- ART EXHIBITS - \$2,635.44
- BALLET - \$1,908.75
- SPECIAL EVENTS - \$733.56
- IRISH DANCE - 470.44
- DANCE PERFORMANCE = \$18.60
- DANCE - 4,748.32
- OTHER DANCE - \$2,637.44
- CU DAYS - \$2,985.24
- DADDY DAUGHTER & MOM PROM - \$531.91
- EGG HUNTS = \$1,168.21
- HALLOWEEN FUNFEST - \$362.16
- STREETFEST - \$884.68
- POTTERY STUDIO - \$5,463.53
- FACILITIES - SPRINGER CULTURAL CENTER - \$2,212.22
- PRAIRIE FARM - \$6,810.22
- CREATIVE KIDS CAMP - \$1,209.74
- SHOWMOBILE - \$142.29

**TOTALS FOR FUND 3 EXCLUDING VIRGINIA THEATRE = \$58,355.47**

GL #	Description	DR	CR
03-01-001-53132	MUS ADMIN - DENTAL INSURANCE		168.84
03-01-001-53133	MUS ADMIN - MEDICAL HEALTH INSURANCE		2,575.22
03-01-001-53134	MUS ADMIN - LIFE INSURANCE		184.42
03-01-001-53137	MUS ADMIN - EMPLOYEE ASSISTANCE PROGRAM		331.18
03-01-001-54208	MUS ADMIN - MEMBERSHIPS, DUES AND FEES		382.50
03-01-001-54209	MUS ADMIN - CONFERENCE AND TRAVEL	3,795.70	
03-01-001-54236	MUS ADMIN - AUTO ALLOWANCE	900.00	
03-01-001-54240	MUS ADMIN - OFFICE EQUIPMENT REPAIRS	200.00	
03-01-001-54241	MUS ADMIN - VEHICLE REPAIR	250.00	
03-01-001-54264	MUS ADMIN - CELL PHONE EXPENSE		13.85
03-01-001-54265	MUS ADMIN - SUBSCRIPTIONS	100.00	
03-01-001-54280	MUS ADMIN - OTHER CONTRACTUAL SERVICES	750.00	
03-01-001-54281	MUS ADMIN - CONTRACTUAL PERSONNEL	500.00	
03-01-001-54282	MUS ADMIN - INTERN STIPEND		500.00
03-01-001-55301	MUS ADMIN - OFFICE SUPPLIES	352.71	
03-01-001-55302	MUS ADMIN - ENVELOPES AND STATIONARY	200.00	
03-01-001-55303	MUS ADMIN - DUPLICATING SUPPLIES	500.00	
03-01-001-55305	MUS ADMIN - PHOTOGRAPHIC SUPPLIES	100.00	
03-01-001-55307	MUS ADMIN - BOOKS AND MANUSCRIPTS	100.00	
03-01-001-55315	MUS ADMIN - STAFF UNIFORMS	100.00	
03-01-001-55327	MUS ADMIN VEHICLE/EQUIPMENT REPAIR PARTS	469.50	
03-01-001-55330	MUS ADMIN - GAS, FUEL, GREASE AND OIL		853.18
03-01-001-55350	MUS ADMIN - RECREATION/PROGRAM SUPPLIES	598.23	
03-01-001-59414	MUS ADMIN - CREDIT CARD FEES		9,051.57
03-01-001-70101	MUS ADMIN - DEPARTMENT HEAD		189.50
03-01-001-70301	MUS ADMIN - OFFICE STAFF/SUPPORT		117.39
03-01-001-70501	MUS ADMIN - MANAGERS/SUPERVISORS		60.90
03-01-001-83003	MUS ADMIN - ALLOWANCES/REIMBURSEMENTS	5,512.41	
03-15-015-54202	PRINTING AND DUPLICATING		1,236.08
03-15-015-54280	OTHER CONTRACTUAL SERVICES	2,344.87	
03-15-015-54281	CONTRACTUAL PERSONNEL		500.00
03-15-015-55307	BOOKS AND MANUSCRIPTS		211.35

Bl.12

03-15-015-55316	YOUTH THEATRE - PARTICIPANT UNIFORMS		397.44
03-15-015-71001	PROGRAM/FACILITY DIR		152.48
03-15-031-54285	TASTE OF CU - CONTRACTUAL ENTERTAINMENT	3,075.44	
03-15-031-54292	TASTE OF CU - SCHOLARSHIPS		3,900.00
03-15-031-55350	TASTE OF CU -RECREATION/PROGRAM SUPPLIES		138.33
03-15-031-55354	TASTE OF CU - FOOD SUPPLIES	2,675.05	
03-15-031-71001	TASTE OF CU - PROGRAM/FACILITY DIR.		711.63
03-15-031-81503	TASTE OF CU - PT GENERAL STAFF		848.05
03-15-032-54281	SUMMER CONCERTS - CONTRACTUAL PERSONNEL	1,000.00	
03-15-032-54285	SUMMER CONCERTS - CONTRACTUAL ENTERT.	1,498.52	
03-15-032-55354	SUMMER CONCERTS - FOOD SUPPLIES	797.36	
03-15-032-71001	SUMMER CONCERTS - PROGRAM/FACILITY DIR.		284.63
03-15-032-81503	SUMMER CONCERTS - PT GENERAL STAFF		512.73
03-15-036-54281	ART EXHIBITS - CONTRACTUAL PERSONNEL		2,625.00
03-15-036-55349	ART EXHIBITS -PLAQUES, AWARDS AND PRIZES		10.44
03-15-036-81003	ART EXHIBITS - PT PRG DIR/SUPERVISOR	2,635.44	
03-15-038-54281	BALLET - CONTRACTUAL PERSONNEL	1,022.00	
03-15-038-71001	BALLET - PROGRAM/FACILITY DIR.		72.72
03-15-038-71401	BALLET - INSTRUCTOR		1,836.03
03-15-038-81403	BALLET - PT INSTRUCTOR	1,908.75	
03-15-068-54204	SPECIAL EVENTS - STAFF MEETINGS		48.71
03-15-068-54285	SPECIAL EVENTS CONTRACTUAL ENTERTAINMENT		200.00
03-15-068-70501	SPECIAL EVENTS - MANAGERS/SUPERVISORS		200.17
03-15-068-71001	SPECIAL EVENTS - PROGRAM/FACILITY DIR.		284.68
03-15-068-81503	SPECIAL EVENTS - PT GENERAL STAFF	902.00	
03-15-140-55316	IRISH DANCE - PARTICIPANT UNIFORMS	210.00	
03-15-140-55350	IRISH DANCE -RECREATION/PROGRAM SUPPLIES	260.44	
03-15-140-71001	IRISH DANCE - PROGRAM/FACILITY DIR.		5.48
03-15-140-81403	IRISH DANCE - PT INSTRUCTOR		464.96
03-15-141-54250	DANCE PERFORMANCE - EQUIPMENT RENTAL	122.70	
03-15-141-54280	DANCE PERFORMANCE -OTHER CONTRACTUAL	1,950.00	
03-15-141-54281	DANCE PERFORMANCE -CONTRACTUAL PERSONNEL	2,599.00	
03-15-141-55354	DANCE PERFORMANCE -FOOD SUPPLIES	175.00	
03-15-141-71001	DANCE PERFORMANCE -PROGRAM/FACILITY DIR.		18.60
03-15-141-71401	DANCE PERFORMANCE -INSTRUCTOR	18.60	
03-15-141-81503	DANCE PERFORMANCE - PT GENERAL STAFF	783.00	
03-15-143-54281	DANCE -CONTRACTUAL PERSONNEL		4,802.30
03-15-143-55354	DANCE -FOOD SUPPLIES	132.28	
03-15-143-71001	DANCE - PROGRAM/FACILITY DIR		53.98
03-15-146-54281	OTHER DANCE - CONTRACTUAL PERSONNEL		2,635.50
03-15-146-55350	OTHER DANCE -RECREATION/PROGRAM SUPPLIES	150.00	
03-15-146-55354	OTHER DANCE - FOOD SUPPLIES	200.00	
03-15-146-71001	OTHER DANCE - PROGRAM/FACILITY DIR		1.94
03-15-146-71401	OTHER DANCE - INSTRUCTOR	327.60	
03-15-146-81403	OTHER DANCE - PT INSTRUCTOR	679.02	
03-15-146-81503	OTHER DANCE - PT GENERAL STAFF	136.12	
03-15-170-54150	CU DAYS - EQUIPMENT RENTAL	1,939.81	
03-15-170-54234	CU DAYS - LANDFILL FEES		146.20
03-15-170-54250	CU DAYS - EQUIPMENT RENTAL		555.00
03-15-170-54285	CU DAYS - CONTRACTUAL ENTERTAINMENT	390.00	
03-15-170-71001	CU DAYS - PROGRAM/FACILITY DIR.	655.43	
03-15-170-81503	CU DAYS - PT GENERAL STAFF		2,284.04
03-15-172-54202	DADDY DAUGHTER -PRINTING AND DUPLICATING	8.91	
03-15-172-54251	CU DAYS - RENTAL FACILITIES	1,168.21	
03-15-172-55350	DADDY DAUGHTER- REC/PRG SUPPLIES		247.28
03-15-172-55354	DADDY DAUGHTER - FOOD SUPPLIES	523.00	
03-15-172-71001	DADDY DAUGHTER PROGRAM/FACILITY DIR.		284.63
03-15-173-54202	EGG HUNTS - PRINTING AND DUPLICATING		9.64
03-15-173-54206	EGG HUNTS - ADVERTISING/PUBLICITY		313.81
03-15-173-55349	EGG HUNTS - PLAQUES, AWARDS, PRIZES		208.26
03-15-173-55354	EGG HUNTS - FOOD SUPPLIES		351.82
03-15-173-71001	EGG HUNTS - PROGRAM/FACILITY DIR.		284.68
03-15-174-54285	HALLOWEEN FUNFEST - CONTRACTUAL ENTERT		220.00
03-15-174-55354	HALLOWEEN FUNFEST - FOOD SUPPLIES	260.16	
03-15-174-71001	HALLOWEEN FUNFEST - PROGRAM FACILITY DIR		142.16
03-15-174-81503	HALLOWEEN FUNFEST - PT GENERAL STAFF	102.00	
03-15-177-54250	STREETFEST - EQUIPMENT RENTAL	884.68	
03-15-177-54281	STREETFEST - CONTRACTUAL PERSONNEL		400.00
03-15-177-54285	STREETFEST - CONTRACTUAL ENTERTAINMENT		200.00
03-15-177-71001	STREETFEST - PROGRAM FACILITY DIR.		284.68
03-30-019-55315	POTTERY STUDIO - STAFF UNIFORMS		30.26

Fond 3. Museum

03-30-019-55350	POTTERY STUDIO - IREC/PROGRAM SUPPLIES	2,013.57	
03-30-019-71001	POTTERY STUDIO - PROGRAM/FACILITY DIR		33.50
03-30-019-81403	POTTERY STUDIO - PT INSTRUCTOR		5,399.77
03-30-030-55301	SPRINGER CULTURAL CTR - OFFICE SUPPLIES		108.92
03-30-030-56231	SPRINGER CULTURAL CTR -GAS & ELECTRICITY		253.20
03-30-030-56232	SPRINGER CULTURAL CTR - WATER		344.18
03-30-030-56233	SPRINGER CULTURAL CTR - TELECOMM EXPENSE		207.00
03-30-030-70301	OFFICE STAFF/SUPPORT		992.30
03-30-030-70901	SPRINGER CULTURAL CTR - CUSTODIAL		306.62
03-30-030-80903	SPRINGER CULTURAL PT BLDG SERVICE WORKER	2,215.71	
03-30-030-83003	SPRINGER CC - ALLOWANCES/REIMBURSEMENTS		3.49
03-30-095-54204	PRAIRIE FARM - STAFF MEETINGS		19.91
03-30-095-54215	PRAIRIE FARM - PROFESSIONAL FEES		1,103.25
03-30-095-54220	PRAIRIE FARM - INSURANCE EXPENSE	816.00	
03-30-095-54242	PRAIRIE FARM - EQUIPMENT REPAIR		74.00
03-30-095-54245	PRAIRIE FARM - BUILDING REPAIR		140.26
03-30-095-54250	PRAIRIE FARM - EQUIPMENT RENTAL		193.50
03-30-095-54255	PRAIRIE FARM - LICENSE AND FEES		35.00
03-30-095-54260	PRAIRIE FARM - SVC CONTRACTS-FACILITIES		46.50
03-30-095-54265	PRAIRIE FARM - SUBSCRIPTIONS		59.85
03-30-095-54299	PRAIRIE FARM - FIELD/SPECIAL TRIPS		42.00
03-30-095-55308	PRAIRIE FARM -FIRST AID/MEDICAL SUPPLIES		4.99
03-30-095-55315	PRAIRIE FARM - STAFF UNIFORMS		92.10
03-30-095-55316	PRAIRIE FARM - PARTICIPANT UNIFORMS		68.26
03-30-095-55320	PRAIRIE FARM - BLDG MTC SUPPLIES	1,295.15	
03-30-095-55321	PRAIRIE FARM - LANDSCAPE SUPPLIES		360.00
03-30-095-55350	PRAIRIE FARM - REC/PRG SUPPLIES	452.93	
03-30-095-55351	PRAIRIE FARM - ANIMAL SUPPLIES	1,013.47	
03-30-095-55354	PRAIRIE FARM - FOOD SUPPLIES		33.41
03-30-095-55355	PRAIRIE FARM - ANIMAL FEED	2,658.68	
03-30-095-56230	PRAIRIE FARM - SANITARY FEES	287.64	
03-30-095-56232	PRAIRIE FARM - WATER		2,938.19
03-30-095-81003	PRAIRIE FARM - PT PRGM DIR/SUPERVISOR	286.35	
03-30-095-81703	PRAIRIE FARM - PT DAY CAMP STAFF		1,599.00
03-50-034-81303	CREATIVE KIDS CAMP - PT ASST DIR/SPVSR	1,209.74	
03-50-034-81703	CREATIVE KIDS CAMP - PT DAY CAMP STAFF		1,209.74
03-60-099-71001	SHOWMOBILE - PROGRAM/FACILITY DIR.		142.29
03-60-099-81503	SHOWMOBILE - PT GENERAL STAFF	142.29	
Journal Total:		58,355.47	58,355.47

APPROVED BY: \_\_\_\_\_

B1.14



CHAMPAIGN PARK DISTRICT

JOURNAL ENTRY

JE: 3892

Entered By: andrea.wallace

Journal: BA

Post Date: 04/30/2018

Entry Date: 06/20/2018

Description: ~~FYE2018 FUND 04 BUDGET LINE TRANSFERS~~

TRANSFER \$6,237 OUT OF VARIOUS INSURANCE LINE EXPENDITURES TO COVER THE OVERAGE IN UNEMPLOYMENT CLAIMS PAID FOR FYE2018 NOT BUDGETED.

TRANSFER \$235 OUT OF CONTRACTUAL PERSONNEL TO COVER OVERAGE IN SALARIES AND BENEFITS FROM ORIGINAL BUDGET AMOUNT DUE TO YEAR-END ACCRUAL.

Total Fund 4 = \$6,479.00  
2.0% of operating budget

GL #	Description	DR	CR
04-01-001-57137	UNEMPLOYMENT PREMIUM		6,237.00
04-01-001-57224	PROPERTY INSURANCE	3,200.00	
04-01-001-57222	EMPLOYMENT PRACTICES	775.00	
04-01-001-57220	LIABILITY INSURANCE	700.00	
04-01-001-57131	WORKERS COMPENSATION	1,562.00	
04-01-001-70501	MANAGERS/SUPERVISORS		213.00
04-01-001-53134	LIFE INSURANCE		16.00
04-01-001-53132	DENTAL INSURANCE		10.00
04-01-001-83003	ALLOWANCES/REIMBURSEMENTS		3.00
04-01-001-53133	MEDICAL HEALTH INSURANCE	7.00	
04-01-001-54281	CONTRACTUAL PERSONNEL	235.00	
Journal Total:		6,479.00	6,479.00

APPROVED BY: \_\_\_\_\_

Fund 15 - CUSR

CHAMPAIGN PARK DISTRICT

JOURNAL ENTRY

JE: 3895

Entered By: andrea.wallace

Journal: BA

Post Date: 04/30/2018

Entry Date: 06/20/2018

Description: **FYE2018 FUND 15 ADMIN BDGT LINE TRANSFER**

FUND 15 ADMIN - BUDGET LINE TRANSFERS

TRANSFER FUNDS FROM FULL-TIME PROGRAM/FACILITY DIRECTOR TO OFFICE STAFF FOR \$582, AND \$302 TO PT OFFICE STAFF SUPPORT TO COVER OVERTAGES AND UNBUDGETED PART-TIME STAFF COVERAGE OF FRONT DESK AT HAYS WHEN FULL-TIME STAFF IS OUT OF OFFICE.

TRANSFER FUNDS OUT OF HEALTH INSURANCE/FICA TO COVER OVERTAGES DUE TO YEAR-END ACCRUAL IN DENTAL INSURANCE \$38, AND FICA PAYMENTS \$378.

TRANSFER OUT OF PRINTING & DUPLICATING (\$1200) AND CONFERENCE & TRAVEL (\$3274) INTO LEGAL PUBLICATIONS/NOTICES \$756 FOR JOB POSTINGS FOR CUSR MANAGER, \$396 FOR ADDITIONAL STAFF TRAINING, \$2280 FOR ATTORNEY FEES ON VARIOUS ITEMS THROUGHOUT THE YEAR, \$892 FOR ADDITIONAL SERVICE CONTRACTS, AND \$150 FOR AN ADDITIONAL WEEK OF INTERN STIPEND NOT BUDGETED.

TRANSFER FROM \$887 FROM ADVERTISING/PRINTING TO WORKERS COMP \$223, LIABILITY INSURANCE \$287, EMPLOYMENT PRACTICES \$51, AND PROPERTY \$326 TO COVER 13% INCREASE IN EXPENDITURES NOT ANTICIPATED AT TIME OF BUDGET.

Total Fund 15 =  
\$66,361.06

9.6% operating budget

GL #	Description	DR	CR
15-25-001-70301	OFFICE STAFF/SUPPORT		582.00
15-25-001-80303	PT OFFICE STAFF/SUPPORT		302.00
15-25-001-71001	PROGRAM/FACILITY DIRECTOR	884.00	
15-25-001-53132	DENTAL INSURANCE		38.00
15-25-001-53133	MEDICAL HEALTH INSURANCE	38.00	
15-25-001-53135	IMRF PAYMENTS	378.00	
15-25-001-53136	FICA PAYMENTS		378.00
15-25-001-54202	PRINTING AND DUPLICATING	1,200.00	
15-25-001-54205	LEGAL PUBLICATIONS/NOTICES		756.00
15-25-001-54207	STAFF TRAINING		396.00
15-25-001-54209	CONFERENCE AND TRAVEL	3,274.00	
15-25-001-54212	ATTORNEY FEES		2,280.00
15-25-001-54254	SERVICE CONTRACTS		892.00
15-25-001-54282	INTERN STIPENDS		150.00
15-25-001-55316	PARTICIPANT UNIFORMS		38.00
15-25-001-55315	STAFF UNIFORMS	38.00	
15-25-001-54206	ADVERTISING/PUBLICITY	887.00	
15-25-001-57131	WORKERS COMPENSATION		223.00
15-25-001-57220	LIABILITY INSURANCE		287.00
15-25-001-57222	EMPLOYMENT PRACTICES		51.00
15-25-001-57224	PROPERTY INSURANCE		326.00
15-25-001-54265	SUBSCRIPTIONS	322.00	
15-25-001-59414	CREDIT CARD FEES		322.00
Journal Total:		7,021.00	7,021.00

APPROVED BY: \_\_\_\_\_

B1.16

CHAMPAIGN PARK DISTRICT  
JOURNAL ENTRY  
JE: 3896

Entered By: andrea.wallace  
Journal: BA

Post Date: 04/30/2018  
Entry Date: 06/20/2018

Description: **FYE2018 FUND 15-BUDGET LINE TXFR WAGES**  
SALARIES & WAGES TRANSFER \$26,876 FROM CUSR ADMIN  
DEPARTMENT SALARIES/WAGES LINE ITEMS TO COVER THE  
OVERAGES IN THE PART-TIME SEASONAL LINES, PLUS  
TRANSFER\$21,976 FROM VARIOUS CUSR PROGRAM  
SALARIE/WAGES LINE ITEMS AS FOLLOWS BY PROGRAM:

- 25-050 CUSR DAYS OUT PROGRAMS TOTAL \$546
- 25-051 CUSR TEEN/CAMP SPIRIT TOTAL \$10,637
- 25-052 CUSR TRANSPORTATION \$1909 NOT BUDGETED BUT  
INCLUDED IN PT DAYCAMP STAFF LINE ITEM #81703
- 25-054 CUSR YOUTH/TEEN PROGRAMS TOTAL \$895
- 25-058 CUSR DANCE TOTAL \$416
- 25-059 CUSR ADULT PROGRAMS TOTAL \$3,060
- 25-060 CUSR AFTERSCHOOL PROGRAMS TOTAL \$23,646
- 25-062 CUSR SPECIAL OLYMPICS TOTAL \$1,970
- 25-064 CUSR FOR KIDS ONLY CAMP TOTAL \$5,333
- 25-091 CUSR SPALDING REC CENTER TOTAL \$440

GL #	Description	DR	CR
15-25-001-70501	ADMIN - MANAGERS/SUPERVISORS	6,960.00	
15-25-001-71001	ADMIN - PROGRAM/FACILITY DIRECTOR	8,116.00	
15-25-001-81503	ADMIN - PT - INCLUSION AIDS ADA	11,800.00	
15-25-052-81703	TRANSPORTATION - PT DAY CAMP STAFF	11,000.00	
15-25-054-81703	YOUTH/TEENS PRGRMS - PT DAY CAMP STAFF	300.00	
15-25-059-81503	ADULT PROGRAMS - PT GENERAL STAFF	1,400.00	
15-25-061-81403	OVERNIGHT TRIPS - OVERNIGHT STAFF	2,056.00	
15-25-062-81703	SPECIAL OLYMPICS - PT DAY CAMP STAFF	5,770.00	
15-25-063-81703	SPORTS & FITNESS-PT DAY CAMP STAFF	1,450.00	
15-25-050-81003	DAYS OUT PROGRAMS -PT PRG DIRECTOR/SPVSR		76.00
15-25-050-81703	DAYS OUT PROGRAMS - PT DAY CAMP STAFF		470.00
15-25-051-81003	TEEN/CAMP SPIRIT -PT PRG DIRECTOR/SPVSR		750.00
15-25-051-81703	TEEN/CAMP SPIRIT - PT DAY CAMP STAFF		9,887.00
15-25-052-81503	TRANSPORTATION PT GENERAL STAFF		1,909.00
15-25-054-81503	YOUTH/TEEN PROGRAMS - PT GENERAL STAFF		895.00
15-25-058-81703	DANCE -PT DAY CAMP STAFF		416.00
15-25-059-81703	ADULT PROGRAMS - PT DAY CAMP STAFF		3,060.00
15-25-060-81003	AFTERSCHOOL PRG - PT PROGRAM DIRECTOR		2,308.00
15-25-060-81703	AFTERSCHOOL PRG - PT DAY CAMP STAFF		21,338.00
15-25-062-81403	SPECIAL OLYMPICS - INSTRUCTORS/OVERNIGHT		396.00
15-25-062-81503	SPECIAL OLYMPICS - PT GENERAL STAFF		1,574.00
15-25-064-81003	FOR KIDS ONLY CAMP- PT PRG DIRECTOR/SPVR		2,653.00
15-25-064-81703	FOR KIDS ONLY CAMP-PT DAY CAMP STAFF		2,680.00
15-25-091-80903	SPALDING REC-PT BUILDING SERVICE WORKER		440.00
	Journal Total:	48,852.00	48,852.00

APPROVED BY: \_\_\_\_\_

B1.17



## CHAMPAIGN PARK DISTRICT

## JOURNAL ENTRY

JE: 3900

Post Date: 04/30/2018

Entered By: andrea.wallace

Entry Date: 06/21/2018

Journal: BA

Description: ~~FYE2018 FUND 15 BUDGET LINE TRANSFERS~~FYE2018 BUDGET LINE TRANSFERS FOR CUSR FUND 15 BY  
DEPARTMENT:

CUSR TEEN/CAMP SPIRIT - \$1,998.58  
 CUSR TRANSPORTATION - \$530.12  
 CUSR YOUTH/TEEN PROGRAMS - \$38.64  
 CUSR SPECIAL EVENTS - \$2,479.89  
 CUSR DANCE - \$300.  
 CUSR ADULT PROGRAMS - \$1000  
 CUSR AFTERSCHOOL - \$36.66  
 CUSR OVERNIGHT TRIPS - \$3,008.03  
 CUSR SPECIAL OLYMPICS - \$424.09  
 CUSR FOR KIDS ONLY CAMP - \$458.09  
 CUSR SPALDING RECREATION CENTER - \$213.96

TOTAL - \$10,488.06

GL #	Description	DR	CR
15-25-051-54251	CUSR TEEN/CAMP SPIRIT -RENTAL FACILITIES		1,640.00
15-25-051-54299	CUSR TEEN/CAMP SPIRIT - FIELD TRIPS	1,142.72	
15-25-051-55322	CUSR TEEN/CAMP -JANITORIAL SUPPLIES		26.51
15-25-051-55350	CUSR TEEN/CAMP SPIRIT -REC/PRGM SUPPLIES		89.10
15-25-051-55354	CUSR TEEN/CAMP SPIRIT -FOOD SUPPLIES		242.97
15-25-052-54241	CUSR TRANSPORTATION - VEHICLE REPAIR	1,135.47	
15-25-052-54255	CUSR TRANSPORTATION - LICENSE AND FEES	57.40	
15-25-052-55330	GAS, FUEL, GREASE AND OIL		530.12
15-25-054-54281	CUSR YOUTH/TEEN - CONTRACTUAL PERSONNEL	2,159.32	
15-25-054-54299	CUSR YOUTH/TEEN - FIELD/SPECIAL TRIPS	289.00	
15-25-054-55350	CUSR YOUTH/TEEN - REC/PRGR SUPPLIES		38.64
15-25-056-54206	CUSR SPECIAL EVENTS - ADVERTISING		302.28
15-25-056-54208	CUSR SPECIAL EV - MEMBERSHIPS, DUES&FEES	3,240.00	
15-25-056-54250	CUSR SPECIAL EVENTS -EQUIPMENT RENTAL	175.00	
15-25-056-54251	CUSR SPECIAL EVENTS - RENTAL FACILITIES		240.00
15-25-056-54280	CUSR SPECIAL EVENTS - OTHER CONTR SRVCS		1,937.61
15-25-056-55349	CUSR SPECIAL EV PLAQUES, AWARDS & PRIZES	715.13	
15-25-056-55354	CUSR SPECIAL EVENTS - FOOD SUPPLIES	1,574.02	
15-25-058-54285	CUSR-DANCE - CONTRACTUAL ENTERTAINMENT		300.00
15-25-059-54281	CUSR ADULT PRGS - CONTRACTUAL PERSONNEL		1,000.00
15-25-060-55354	CUSR AFTERSCHOOL - FOOD SUPPLIES		36.66
15-25-061-54299	CUSR OVERNIGHT TRIPS-FIELD/SPECIAL TRIPS		3,008.03
15-25-062-55354	CUSR SPECIAL OLYMPICS - FOOD SUPPLIES		424.09
15-25-064-55350	CUSR FOR KIDS ONLY CAMP - PRGM SUPPLIES		452.81
15-25-064-55354	CUSR FOR KIDS ONLY CAMP -FOOD SUPPLIES		5.28
15-25-091-54245	CUSR SPALDING REC CTR - BUILDING REPAIR		186.40
15-25-091-55322	CUSR SPALDING REC CTRJANITORIAL SUPPLIES		3.34
15-25-091-56232	CUSR SPALDING REC CTR - WATER		21.37
15-25-091-56233	CUSR SPALDING REC CTR - TELECOMM EXPENSE		2.85
Journal Total:		10,488.06	10,488.06

APPROVED BY: \_\_\_\_\_

B1.18



Fund 11. Activity

CHAMPAIGN PARK DISTRICT

JOURNAL ENTRY

JE: 3890

Post Date: 04/30/2018

Entered By: andrea.wallace

Entry Date: 06/20/2018

Journal: BA

Description: **FYE18 FUND 11 BUDGET LINE TRANSFERS**

TRANSFER OF FUNDS FROM OFFICE SUPPLIES LINE ITEM (\$750) AND \$72 FROM PROGRAM SUPPLIES LINE ITEM TO COVER ADDITIONAL PURCHASES MADE FOR FLOWERS & CARDS (GET WELL, SYMPATHY, ETC) \$215; AND FOOD SUPPLIES FOR STAFF EVENTS OF \$607.

GL #	Description	DR	CR
11-80-001-55301	FYE18 FUND 11 BUDGET LINE TRANSFERS	750.00	
11-80-001-55348	FYE18 FUND 11 BUDGET LINE TRANSFERS		215.00
11-80-001-55354	FYE18 FUND 11 BUDGET LINE TRANSFERS		607.00
11-80-001-55350	FYE18 FUND 11 BUDGET LINE TRANSFERS	72.00	
Journal Total:		822.00	822.00

APPROVED BY: \_\_\_\_\_

B1.19

CHAMPAIGN PARK DISTRICT

JOURNAL ENTRY

JE: 3887

Entered By: andrea.wallace

Journal: BA

Post Date: 04/30/2018

Entry Date: 06/20/2018

Description: **FYE2018 BUDGET LINE TRANSFER FROM A&E**

TRANSFER FROM A&E LINE ITEM TO COVER PRINTING OF \$29 AND PROFESSIONAL FEES OF \$7100 RELATED TO THE ORIGINAL COST STUDY OF MARTENS CENTER BROCHURE & ESTIMATE.

GL #	Description	DR	CR
27-01-001-54202-180012	PRINTING AND DUPLICATING		29.00
27-01-001-54215-180012	PROFESSIONAL FEES		7,100.00
27-01-001-54214-180012	ARCHITECT AND ENGINEERING FEES	7,129.00	
Journal Total:		7,129.00	7,129.00

APPROVED BY: \_\_\_\_\_

Bl.20